



*Prime
Inventions*



Products for pure water

COMPANY

COUNTERTOP FILTER



UNDERSINK FILTER



FAUCETS



WATERWHIRLER



OSMOSIS



COMPANY	4
Warehouse	5
Mission statement	6
COUNTERTOP FILTER	7
SANUNO INOX	8
AA Mercurio	9
AA UNO VA	10
AA DUO VA	11
SANUNO	12-13
AA Single	14
AA Double	15
SANUNO GRANDE	16
UNDERSINK FILTER	17
AA Inline	18-20
AA Single Profi	21
AA Double Profi	22
AA Triple Profi	23
DUO HPP	24
DUO HPS	25
VARIO HP	26
Shower filter SF-89	27
Leak-Controller	28
FAUCET	29
F28 Triple	30
F29 Tina	31
F19S Nena	32
WS8 - WS8 P	32
WS-6	33
WS-7	33
Bellima Tea filter	34
WATERWHIRLER AND BOTTLES	35
Aquawhirler AW-888	36
Eggy whirler WE-888	37
Aquawhirler Inline	38
Aquawhirler Mega	39
Aquawhirler Piccolo	40
Aquawhirler Perlo	41
Aquawhirler Inline 9VAL	42
Whirlators	43-44
EM Ceramics	45
Water Vitalis drinking bottles	46-47
Water Vitalis replacement	48
OSMOSIS	49
AA Osmo	50-51
AA Osmo Profiline	52-53
Why anti lime scale?	54



HOUSE- AND WELL WATER



FILTER CARTRIDGES KITCHEN



AA INLINE FILTER CARTRIDGES



HOUSE- AND WELLWATER CARTRIDES

HOUSE- AND WELLWATER FILTER	55
AA Fidelo	56-58
KALKO INNOVA	59
KALKO INNOVA Bags	60
KALKO INNOVA Classic Line	61
KALKO INNOVA Big Green	62
NH-1 Kombianlage	63
LEX Plus 10 connect	64-65
Carbonit® Quadro	66
FILTER CARTRIDGES KITCHEN	67
EM Premium 5	68
EM Premium D	69
EM Puro	70
EM Aquawhirler	71
NFP-Premium	72
IFP-KDF	73
IFP-Puro	74
AA Calci	75
EK-7S not regenerable	76
EK-6H regernerable	76
SC-99 Sediment filter	77
Membrane filter for AA UNO/TWIN	78
Sedimentf ilter for AA UNO/TWIN	79
EM-Premium for AA UNO/TWIN	80
Filter granules	81-82
AA INLINE FILTER CARTRIDGES	83
EM Premium 5 Inline	84
FP-6 Virusfilter	84
EM IFP Inline	85
EM SC 99 Inline	85
EM Calci Inline	86
EK 7 Inline	86
HOUSE- AND WELLWATER FILTER	87
BB EM filter	88
Pentek DGD	89
Pentek Carbon filter	89
Pentek Carbon filter	90
Pentek Iron filter	90
Big Green cartridges	91
Quadro filter cartridges	92
Membrane filter	93
Lineguard	94
Exhibitions	95



Dear Business Partner

Today you have your hands on the new catalogue for 2021. In 2019 Prime Inventions celebrated its 15-year anniversary with a very special Christmas present for its customers. In addition, we made a donation through PRIMAKLIMA e.V that enabled 100 trees to be planted which are now doing their bit for the environment. Environmental consciousness can also be found in our vehicle fleet. The Prime Inventions management team only drives electric vehicles, charged with 100% hydroelectric power. You can look forward to lots of new and innovative products in 2020. In August 2019 the European Patent Office issued our long-awaited patent for the new water whirling system under the number WO 2017/084711 A1. The patent was the basis for the development of the Aquawhirlers: AW-9000, AW-26, AW-9 V4A and the AW Perlo.

The new under-counter filter system AquaAvanti Profi/Gastro helps protect the environment and save resources. The filter stages for softening, or removal of selective substances such as nitrate, arsenic etc. are equipped with a diffuser. As a result filled cartridges are no longer needed, which saves a lot of plastic. A further advantage is the 100% larger filling quantity/capacity compared to use with pre-filled cartridges.

I would particularly like to mention the new Sanuno Grande from Carbonit® which, after many years of development, has proven a true masterpiece with its terrific design. For the water softening systems and accessories sector Prime Inventions has developed a new and strong partnership with the company, SYR, in Korschenbroich, where joint training courses are also taking place.

The computer system was also not completely up to date and, for example, all price lists are now generated directly from the merchandise management system. As a result there is one, uniform database, fewer errors, and the option to have individual price lists.

Four new employees have joined us during the past year or so. Since January 2020 our son, Oliver, following 25 years of professional experience in other sectors, has been completely in control of procurement at Prime Inventions.



CEO Sia Sofia Suttner



Showroom



Small training room

The issue of our medium-term succession is thus assured. Our long-term succession had already been secured through the taking on of our grandson, Luis, within the company in 2017. Prime Inventions is strategically well positioned for the future. Expansion into foreign markets has been extensively strengthened by trade fairs in Singapore and Malaysia and an acquisition trip to South America where clients were acquired in Uruguay, Chile and Paraguay.

All across the world, Prime Inventions develops and maintains innovative products related to clean water. The products are known globally under their own trademarks, Aquawhirler, Kalkolnnova, Wirblei, Mercurio, Eggy Whirler, AquaAvanti and YaraOvi. We supply approx. 500 dealers all across Germany. We have sales partners in almost all European countries, some of which have exclusive status.

Prime Inventions also supplies numerous "private labels" as well as exclusively developed products to well-known companies from the water technology sector. German workmanship should secure jobs and provide Prime Inventions' clients with a high degree of security. Purchased trade products are combined or enhanced with our own products. We have sales channels all across the globe, including: importers, distributors, wholesale traders, the mail-order trade and specialist retailers. Our management has over 25 years of experience in water technology.



LTR Oliver Cremer, Luis Belchhaus



Warehouse storage

Warehouse

Prime Inventions has a shipping warehouse with approx. 400 m² of space for quick and easy shipping of smaller orders and an extra high rack pallet stock with capacity of over 100 pallets



Testing-room



MISSION STATEMENT PRIME INVENTIONS

Our mission: Clean, quality water worldwide

How our business interacts with the surrounding environment:

1. Customers:

Customers are our most important partners as they make up the basis for Prime Inventions' existence. We value our personal customer relationships very highly. We include our customers in the further development of products as far as possible. All complaints and criticisms are checked and taken very seriously. Prime Inventions goes the extra mile for our customers in design and product support. We support new start-ups and smaller companies as far as possible. Honest communication is important to us and customers will be informed immediately about developments which are negative for them.

Generous compensation will be offered in the event of justified complaints ; feedback is seen as an opportunity for closer customer relations.

2. Employees

Employees are valued and promoted by the management. All employees value each other and help each other. The word „bullying“ is and remains a foreign word at Prime Inventions and will not be tolerated. Prime Inventions pays out bonuses to employees for special services and achievement of goals in order to allow them to participate in the company's success. Suggestions for improvement are welcome and rewarded. Great importance is attached to occupational safety. Every employee adheres to the established occupational protection regulations and immediately draws attention to risk areas as soon as they become apparent.

3. Products:

We only offer quality products, most of them „Made in Germany“. Quality is always given priority over the manufacturing and buying price. We try to make all Prime Inventions products with the lowest possible effect on the environment. This includes adapting to the latest standards.

4. Suppliers:

Prime Inventions handle their suppliers like customers and include them in product development to a large extent. In the negotiation of prices, we give quality, long term cooperation and the preservation of livelihoods priority.

5. Competitors:

Competitors are seen by Prime Inventions as potential customers and suppliers and we acknowledge their products. We work towards closer cooperation to increase the market for the products the sector produces.

6. Cultures and minorities:

We take cultural values in different countries and the rights of minorities into account in our advertising, business communications and the behaviour of our employees. All cultural groups are dealt with equally.



SUITABLE
FILTER CARTRIDGES
FROM PAGE 69

COUNTERTOP FILTERS



PRIME INVENTIONS COUNTERTOP FILTERS

... can be quickly and easily fitted onto the faucet. The filter housing (also available as double-stage) then stands on or beside the sink. The cold water passes through the filter via a switching valve connected to the faucet outlet via a hose. The filtered water is then drawn directly from the outlet pipe of the filter housing. Extremely well suited for the preparation of drinks, and cooking water etc. Service water is then tapped by turning the lever on the switching valve to the vertical position.

Suitable for Carbonit® Filter Cartridges

Carbonit® home filter cartridges fit into the Prime Inventions countertop filters

Our tip: Together with Carbonit®, Prime Inventions has developed exclusive filter cartridges with additional functions such as water energization and whirler functions.

Compatible filter cartridges: see page 69

ATTENTION!

- **Do not operate countertop filters on “depressurized boilers”**
- **Do not operate on a shower faucet**
- **Due to the design of the filter cartridges available, only operate with cold water**
- **Protect from frost**

Connect to standard kitchen faucets with external thread (M22x1) with the supplied special switching valve.

Model	Shortcode	Housing	Features
Carbonit® SANUNO inox	125UNOVA	Stainless steel	High quality stainless steel filter from Carbonit®
AA Mercurio	ME-3 ME-6	Stainless steel	High quality stainless steel filter with easy-to-clean, hygienic surfaces. Simple filter change
AA UNO VA	AV-UNO	Stainless steel	Stainless steel compact stainless steel design filter from Prime Inventions
AA TWIN VA	AV-TW	Stainless steel	Stainless steel double-filter system from Prime Inventions Two filter cartridges can be operated in series.
Carbonit® SANUNO	SAN	Polypropylene	Double-filter system from Prime Inventions Two filter cartridges can be operated in series.
AA Single	AS-1	Polypropylene	Solid, inexpensive countertop water filter from Prime Inventions.
AA Double	AD-2	Polypropylene	Double-filter system from Prime Inventions Two filter cartridges can be operated in series.
Carbonit® SANUNO GRANDE	SAN-GR	Polypropylene	Polypropylene stylish design countertop filter with stainless steel outlet and whirler

COUNTERTOP FILTER



carbonit®

FILTER MADE IN GERMANY

SANUNO INOX

Stainless steel filterhousing from CARBONIT®

Here you will find a special, high-quality housing in a flashy „design variant“ made from stainless steel. Ready for installation, filter units for immediate connection.

Very suitable for the preparation of beverages, cooking water etc .. Use for drinking water only. Accordingly, only suitable for cold water operation. The housing is made of high quality of the drinking water standard corresponding stainless steel (V4A).

The tubing (in gray) from the filter to the diverter faucet is made of unplasticized silicone.



NFP-Premium included

The housing cap is easy to open by screwing for changing the filter cartridge.



SANUNO INOX

Art. No.	125UNOVA1 / 125UNOVA2
Shortcode	Inox S / Inox F
Weight	2,9 (2,7) kg complete - dry 4,2 (4,0) kg complete - wet
Dimension with tap	Diameter 10 cm x L 42 cm
Material	Housing, spout, lid and stand stainless steel - Stainless steel. Inner bottom, outlet cap - POM
Flowrate	max. approxca. 2 l/min. by 4bar with NFP Premium
Pollutant reduction	see data sheet of the filter cartridge
Packaging Unit	4 pieces
Box LxWxH	39,5 x 22,5 x 22,5 cm
Box PU 4 St.	80 x 45 x 25 cm

Weight PU4 St.	16 kg
Customs number	84212100
EAN number	VA1: 4250188803665 VA2: 4250188803658
Scope of delivery	Complete filter housing with connection hose, Changeover valve and NFP filter cartridge
Height tap	39 cm
Pallet	24 boxes x 4 = 96 pieces
Manufactured for	9 3/4" filter cartridges Carbonit®
Main location	Kitchen
Min. operating pressure	ca. 1 bar, ideal 3-4 bar
Restrictions on use	Use only cold water Not behind unpressurized boilers!

Service life of the filter cartridges see at page 69

COUNTERTOP FILTER

AQUA AVANTI MERCURO

Compact and elegant - stainless steel



A feast for the eyes in the kitchen - the installation is very easy and it can be attached to the original faucet from your sink using a high quality silicone hose.

- solid stainless steel case
- brushed surface (stainless typical)
- easy to open
- easy to clean
- outlet tube made of stainless steel
- high quality silver colored silicone hose
- good stability even with heavy water whirler

The AA Mercurio can be easily cleaned with a microfiber doth.

**ME-6 with
EM Premium 5**



AA MERCURO

Art. No.	ME-3 90000182 ME-6 90000183	Weight PU 6 pieces	22,3 kg
Shortcode	ME-3 - without filter cartridge- ME-6 - with EM Premium 5	Customs number	84212100
Weight	3,6 kg	EAN number	ME-3 4250188806505 ME-6 4250188806420
Height	290 mm	Output	Depending on filter cartridge
Diameter	150 mm	Scope of delivery	AD288, Changeover valve, AD5, housing key, 1 m hose
Height tap	300 mm	Manufactured for	9 3/4" filter cartridges Carbonit®
Material Housing	Stainless steel	Main location	Kitchen
Material hose, length	1m high quality drinking water certified silver colored silicone hose	Min. operating pressure	approx. 1 bar, ideal 3-4 bar
Box LxWxH	11 x 13 x 36 cm	Restrictions on use	Use only cold water Not behind unpressurized boilers!
Box PU 6 Pieces HxBxT	40 x 28,5 x 35,5 cm	Service life of the filter cartridges see at page 69	

COUNTERTOP FILTER

AQUA AVANTI UNO VA

Stainless steel design countertop filter

- Space-saving design
- With secure filter cartridge holder
- Thread with O-ring - no housing key required
- Including stainless steel switching valve and silicon inlet water hose
- For this housing, and exclusively for Prime Inventions, Carbonit® manufactures the EM Uno Special Filter Cartridge, based on an ILP Premium.

Optional accessories:

- AD-288 outlet pipe for water whirler, water whirler, FC-EUN carbon filter, SF-66 sediment filter, and MF-1 membrane filter

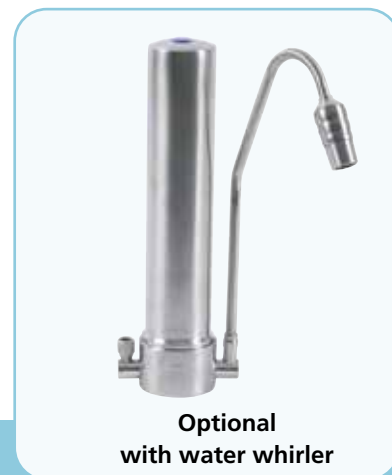
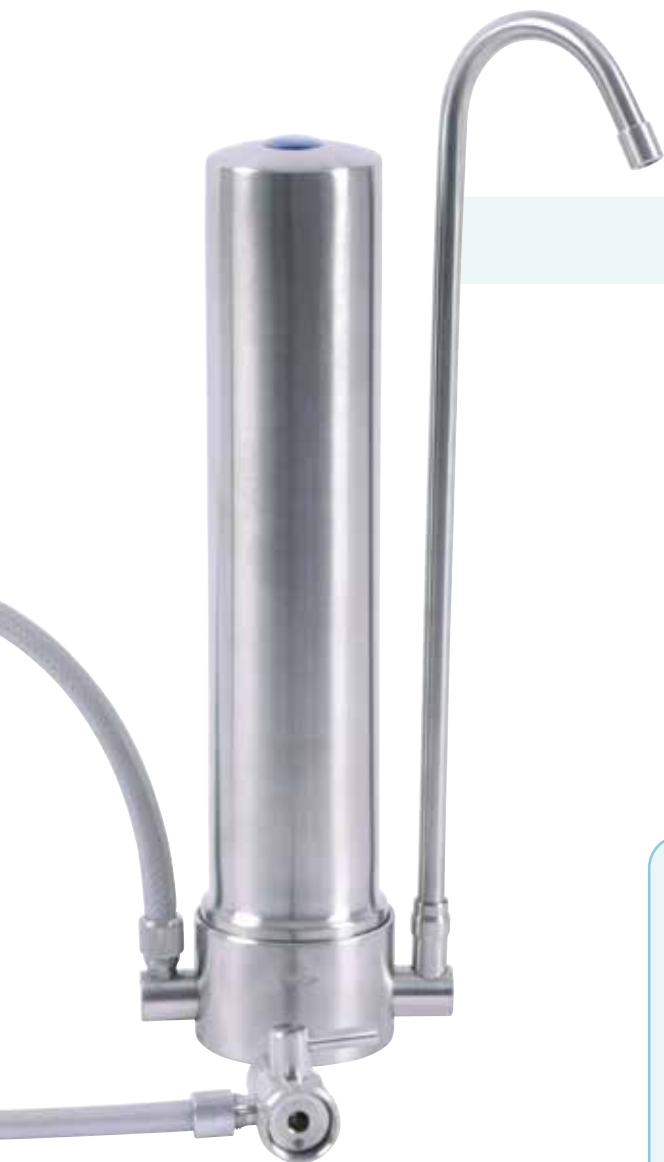

AA UNO VA

Art. No.	90000338
Shortcode	AV-UNO
Weight	1000g net
Length width, height	approx. 67x100x300mm
Height	350mm (until pipe end)
Material housing - valve	Brushed stainless steel
Material hose, length	quality drinking water certified silver colored silicone hose, 1m
Flowrate	Depending on filter cartridge max. ca. 10 l/min.
Box L x W x H	110 x 110 x 365mm, 1,3kg
Box PU 12 St.	360 x 480 x 400mm
Weight PU 12 pieces	approx. 17kg inc. box

Customs number	8421 2100
EAN Number	4250188803313
Scope of delivery	AD288, Changeover valve, AD5, 1 m hose, housing key not necessary
Manufacturer	Prime Inventions GmbH
Pallet	24 boxes x 12 =288 pieces
Connection to water tap	With Changeover valve M24x1 IG
Main location	Kitchen
Min. operating pressure	approx. 1 bar, ideal 3-4 bar
Restrictions on use	Use only cold water Not behind unpressurized boilers!

COUNTERTOP FILTER



AQUA AVANTI TWIN VA

Stainless steel countertop filter - 2 stages

INNOVATION

Use the SF-66 sediment filter as a preliminary stage when treating sediment-containing water to extend the service life of the FC-EUN main filter stage. Alternatively, you can also combine the MF-1 membrane filter with the SF-66 sediment filter to achieve a high reduction in bacteria and viruses getting through.

Optional accessories:

- AD-288 outlet pipe for water whirler, water whirler, FC-EUN carbon filter, SF-66 sediment filter, and MF-1 membrane filter



Optional with waterwhirler

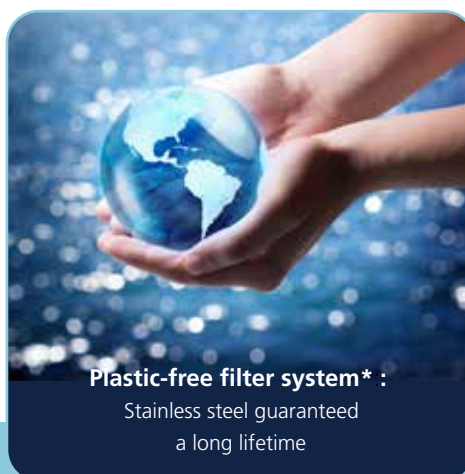

Plastic-free filter system* :
Stainless steel guaranteed
a long lifetime



**Safe connection of
thread and seal**

AA TWIN VA

Art.No.	90000339	Weight PU	approx. 25kg inc. box
Shortcode	AV-TW	Customs number	8421 2100
Weight	2.255g net	EAN number	4250188803320
Length, width, height	approx. 115x200x315mm	Scope of delivery	AD288, Changeover valve, AD5, 1 m hose, housing key not necessary
Height	365mm (until pipe end)	Manufacturer	Prime Inventions GmbH
Material housing and valve	Brushed stainless steel	Pallet	288 pcs.
Material hose, length	quality drinking water certified silver colored silicone hose, 1m	Connection to water tap	With changeover valve M22x1 IG
Flow rate	Depending on filter cartridge max. ca. 10 l/min.	Main location	Kitchen
Packaging Unit	8 Pieces	Min. operating pressure	approx. 1 bar, ideal 3-4 bar
Box	120x210x380mm, 3kg	Restrictions on use	Use only cold water Not behind unpressurized boilers!
Box PU	440 x 500 x 400mm		

* Excluding seals, hoses and caps from filter cartridges

COUNTERTOP FILTER

carbonit® **SANUNO**
FILTER MADE IN GERMANY

CLASSIC / BASIC / VITAL / SAVER SET



This classic Carbonit® product can be quickly and easily fitted onto the faucet.

The filter housing is then on or beside the sink.

The filtered water is drawn directly from the outlet pipe of the filter housing.

Extremely well suited for the preparation of drinks and cooking water, etc.

Service water is tapped by simply turning the lever on the switching valve of the faucet.

SANUNO Vital SA-V1
 SANUNO special model with
 EM Premium D + Eggy whirler

SANUNO

Art. No.	See next page
Shortcode	See next page
Weight	1,3 kg net
Height	300mm
Height tap	270 mm
Diameter	122mm
Material housing	Housing PP
Material hose,length	Plasticizer free PVC-U 90 cm
Flow rate	Max. ca. 120l/min. at 4 bar
Box LxWxH	14 x 14,5 x 35 cm
Box PU 8 St.	60 x 40 x 35 cm

Weight PU 8 St.	approx. 16 kg
Customs number	84212100
EAN number	See next page
Scope of delivery	Complete filter housing with connection hose, Changeover valve and filter cartridge
Manufactured for	9 3/4" filter cartridge Carbonit®
Main location	Kitchen
Min. operating pressure	approx. 1 bar, ideal 3-4 bar
Restrictions on use	Use only cold water Not behind unpressurized boilers!

Service life of the filter cartridges see at page 69

COUNTERTOP FILTER

carbonit® **SANUNO**
FILTER MADE IN GERMANY



CLASSIC

- with NFP Premium-9
- standard model
- PP-Housing

BASIC

- without filter cartridge
- standard model
- PP-Housing

VITAL

- with EM-5 Premium D
- + Vitalizer (Re-Vitalizer)
- + Eggly Whirler
- PP-Housing

SAVER SET

- 2xNFP Premium-9
- standard model
- PP-Housing
- rubber duck

Art. No.	125UNOST	125UNOST-OP	125UNOV4	125UNOV5
Shortcode	SAN CL	SAN BA	SAN VI	SAN SP
EAN Number	4024875900018	4024875146430	4024875143743	4024875146454

SANUNO CLASSIC GREY

SANUNO Classic Grey is identical with the white model. The grey model is additionally prepared with a configurable display for cartridge changing by hand (at the top of the lid clip).

Art.Nr.	125UNOSTG
Shortcode	SAN CLG
EAN Number	4250188803689



AQUA AVANTI SINGLE

Exclusive by Prime Inventions

The AquaAvanti Single is a solid countertop filter equipped with an outlet pipe and outlet pipe holder made from stainless steel. Thanks to the M22x1 thread on the outlet pipe, an aquawhirler can be connected directly as soon as the cap is removed.

Generally only supplied with an original Carbonit® filter cartridge. As standard, an EM Premium 5 Filter Cartridge is provided in the delivery.

Carbonit® and Prime Inventions filter cartridges of the NFP, IFP and EM series, and 9 3/4" in size, fit into the housing. There is an option for another outlet pipe.



Precycling instead of Recycling
Create less waste! Amazing drinking water - directly from your tap



Scope of delivery

AA SINGLE

Art. Nr.	90000061
Shortcode	AS-1
Weight	approx. 1,3 kg net
Height	approx. 330mm
Height tap	approx. 310mm
Diameter	approx. 122mm
Material Housing	Polypropylen
Flow rate	ca. 2 l/min

Performance	Max. approx.. 120l/min. at 4 bar
EAN number	4250188806178
Scope of delivery	Complete filter housing with connection hose, Changeover valve and filter cartridge
Manufactured for	9 3/4" filter cartridges Carbonit®
Main location	Kitchen
Min. operating pressure	approx. 1 bar, ideal 3-4 bar
Restrictions of use	Use only cold water Not behind unpressurized boilers!

Service life of the filter cartridges see at page 69

AQUA AVANTI DOUBLE



Double Filter System

In the larger brother of the AA Single two filter cartridges can be operated in series. Use a sediment filter to increase the service life of the main filter cartridge through pre-filtering, or, for example, use a scale cartridge in addition to water filtering.

A wall bracket is included in the scope of delivery with which the device can be securely fixed to the wall. The water is supplied by means of a supply hose which is connected to the outlet of a standard faucet with M24x1 thread, with the help of a metal switching valve.

Generally only supplied with an original Carbonit® filter cartridge. As standard, an EM Premium 5 Filter Cartridge is provided in the delivery. Carbonit® and Prime Inventions filter cartridges of the NFP, EM series, and 9 3/4" in size, fit into the housing.

EXAMPLES FOR POSSIBLE FILTER ARRANGEMENTS

1. Stufe	2. Stufe	Vorteile
Sedimentfilter	Carbonfilter	Longer service life of the main filter stage when used, for example, with sediment-heavy water etc.
Anti limescale filter	Carbonfilter	Perfect for drinks, tea, coffee machines
Nitrate or arsenic / fluoride reduction	Carbonfilter	for special pollution reduction
IFP KDF filter from Carbonit®	Carbonfilter	for special pollution reduction

AA DOUBLE

Art. No.	90000080
Shortcode	ADD-2
Weight	approx. 2,4 kg net
Height	approx. 330mm
Height tap	approx. 310mm
Diameter	approx. 122mm
Material Housing	Polypropylen
Flow rate	approx. 2 l/min

Performance	Max. approx. 120l/min. at 4 bar
EAN number	4250188806185
Scope of delivery	Complete filter housing with connection hose, Changeover valve and filter cartridge
Manufactured for	9 3/4" filter cartridges Carbonit®
Main location	Kitchen
Min. operating pressure	approx. 1 bar, ideal 3-4 bar
Restrictions of use	Use only cold water Not behind unpressurized boilers!

Service life of the filter cartridges see at page 69

COUNTERTOP FILTER

 **carbonit®** **SANUNO GRANDE**
FILTER MADE IN GERMANY

The newly filter design from Carbonit®

The popular Carbonit® Sanuno countertop water filter in a new, breath-taking design with an additional replacement filter cartridge, All the benefits and functions of the Carbonit® Sanuno Classic can also be found in the new SANUNO GRANDE (see page 13)

SANUNO GRANDE Water Filter for installation on the sink faucet with special switching valve for simple selection between filtered and unfiltered water.

Simply screw the special switching valve onto the faucet - done!

With integrated Prime Inventions water whirler system, as internationally patented under Patent No. WO 2017/084711.



SANUNO GRANDE

Art. Nr.	125UNOGRANDE
Shortcode	SANGR
Weight	1650 g
Height	310 mm
Diameter	110 mm
Material housing	Polypropylene
Material hose	Silicone
Filter cartridge	NFP Premium
Box LxBxH	387 x 215 x 219 mm
Box PU 4 St.	794 x 456 x 228
Weight PU 4 St.	10 kg

Customs number	84212100
EAN number	402 487 514 6447
Scope of delivery	Complete filter housing with connection hose and 2 filter cartridges
Height tap	210 mm
Pallet	60 pieces
Main location	Kitchen
Restrictions of use	Use only cold water Not behind unpressurized boilers!
Service life of the filter cartridges	see at page 69

SUITABLE
FILTER CARTRIDGES
FROM PAGE 69



PRIME INVENTIONS UNDER-SINK FILTERS

... can be quickly and easily fitted below the sink.

With the under-sink devices there are essentially **3 different installation variants:**

- 1. Installation with separate faucet**
A flexible hose leads from the T-piece into the filter housing, and a further one to a separate drinking water faucet in the sink (drill-hole required)
- 2. Installation with 3-way faucet**
Replacement of the existing faucet with a 3-way faucet.
Attention: do not operate in connection with depressurized boilers!
- 3. Filtering of all cold water**
No T-piece behind the corner valve, all of the cold water runs through the filter.

Suitable for 9 3/4" Carbonit® filter cartridges

9 3/4" Carbonit® filter cartridges and Prime Inventions exclusive filter cartridges fit into the under-sink filters. (Excluding membrane filters and travel filters)

Our tip: Together with Carbonit®, Prime Inventions has developed exclusive filter cartridges with additional functions such as water energization and whirler functions.

Our compatible filter cartridges: see from page 69 on

ATTENTION!

- **Due to the design of the filter cartridges available, only operate with cold water**
- **Protect from frost**

Model	Shortcode	System	Features
AA Inline	HF / EW / FP	many stages	Cartridges in a quick change housing. Many stages possible
AA Single Profi	ADP-0	one stage	One stage professional filter from Prime Inventions - usable with filter cartridges or granulate
AA Double Profi	ADP-2	two stages	Two stage professional filter from Prime Inventions - usable with filter cartridges or granulate
AA Triple Profi	ADP-3	three stages	Three stage professional filter from Prime Inventions - usable with filter cartridges or granulate
Carbonit® DUO	125UNOVA	two stages	Parallel or serial double filter in many sets
Carbonit® Vario HP	VARIO	one stage	Flexible and inexpensive model for many fields of application
Membrane filter	MF-2000	one stage	Ultrafiltration - reduction of bacteria and viruses
Page 93			usable as additional filter

UNDERSINK FILTER

AQUA AVANTI INLINE

Innovation by Prime Inventions



Forget having to dismantle and screw on the filter housings when changing filters. With the AA Inline filter system you can change the filter cartridges in seconds. For this, simply remove the filter cartridge by turning anti-clockwise and insert a new filter cartridge vice versa. Finished. You do not need a housing key anymore. Because you do not come into contact with the inside of the filter cartridge, the exchange occurs very hygienically.

You can, e.g., install an expansion stage with sediment pre-filter in front of the main filter stage in order to extend the service life of the main filter cartridge. Other extension stages help, e.g. as lime-scale protection or in the de-mineralization of the water. Consult with your specialist supplier.

The accompanying faucet adapter has a 3/8" standard thread and so fits to all faucets offered by Prime Inventions. An adaptation to other threads, e.g. to UNS 7/16-24, is optionally possible. For easy connection to the angle valve under the sink, a high-quality European terminal adapter ASV-7 JG is supplied with every main filter stage

AA INLINE

Art. No. + Shortcode	see table
Weight filter head	with EM filter cartridge approx. 960 gr with SC-99 approx. 610 gr
Height	approx. 320 mm
Width	approx. 100 mm
Material Housing	PP housing
Flow rate	2-8 l/min
Box PU	10 pieces

Pallet	20 boxes x 10 = 200 pieces
Manufactured for	9 3/4" filter cartridges Inline
Main location	Kitchen
Min. operating pressure	approx. 1 bar, ideal 3-4 bar
Restrictions of use	Use only cold water
Service life of the filter cartridges	see at page 69

A leak controller is included in the scope of delivery

OVERVIEW MODULES AND CARTRIDGES

Inline EM 5 Premium

Inline EM IFP Premium

Inline SCI-99

Inline EM Calci Mineralisation with EM Pipes

Inline EK7 anti lime scale

Inline FP-7 virus filter

FUNCTION

water filtering and enlivenment

filtering and enlivenment by low water pressure

antibacterial sediment filter

mineralisation e.g. after osmosis

Anti lime scale (anion exchanger)

Prefilter stage for virus filtering

UNDERSINK FILTER

CONSTRUCTION OF INLINE FILTER SYSTEM

The basic system requires a **MAIN FILTER STAGE**.
This is expandable with one or more **EXPANSION STAGES**.

MAIN FILTER STAGE

The main filter stage always consists a filter cartridge, the cartridge head, connection and 2 hoses. The system can then be used as a stand-alone filter or with one or more expansion stages. Including Leak controller.



EXPANSION STAGES

The expansion stage also consists a filter cartridge and the filter head, but a shorter connection hose for connecting to the main filter stage.



REPLACEMENT FILTER CARTRIDGES

At the end of the prescribed useful life of the filter, the filter cartridges must be exchanged. Please just order the replacement cartridges under the item number given below.



AS MAIN FILTER STAGE (HF)

HF-1 / 88802668

HF-2 / 88802699

AS EXPANSION STAGES(EW)

EW-1 / 88802750

EW-2 / 88802774

EW-3 / 88802781

EW-4 / 88802798

EW-5 / 88802804

EW-7 / 90000570

RPL. CARTRIDGES (FP)

FP-1 / 88802200

FP-2 / 88802286

FP-3 / 88802217

FPI-4 / 88802163

FP-5 / 88807984

FP-7 / 90000569

UNDERSINK FILTER

VIRUS FILTERING NOVELTY EW-7

As a supplement to our successful AA inline filter system, the EW-7 was developed. This additional stage filters viruses out of the drinking water and works with the patented Filter material Disruptor® from Ahlstrom. It is recommended to use the EW-7 after the pre-filtering and after the activated carbon block so that it can be used as long as possible. A solo use, or only with a pre-filter stage before it is also possible, but reduces the usage time and filter performance. By cleverly wrapping the filter material and the resulting large surface, a Water flow of approx. 4 liters / min. and a usage time of up to 5,000 liters can be achieved. Further informations on page 84.



Compressor for leaktesting



Installation school / Barcelona



QUICK-CONNECT

Connection between the filter housing and head



Installation example camper

Especially for motor homes / caravans, a new variant is available which includes a connection set for easy installation. The same system is also very good for houseboats and yachts.

INLINE EM 5 PREMIUM

water filtration and water revitalization with connection kit for campers HF-1W 62403000

INLINE EM IFP PREMIUM

Premium Filtering for line pressure, water filtration and Water revitalization with connection set for campers HF-2W 62404000



AQUA AVANTI SINGLE PROFI

Undersink filter with high pressure stability

Professional system for efficient water filtering, The AA Single Profi is fitted discreetly under the sink, You can then either draw your drinking water via a separate faucet or a special three-way faucet which dispenses both service water and the filtered drinking water via separated pipes.

- Professional filter system made from polypropylene with high pressure stability.
- Use with carbon filters, further stages can alternatively have filter granulate for, for example, water softening (with optional diffusor)
- Secure installation as the inlet and outlet are equipped with integrated brass thread inserts.

Optional accessories:

- AP-75 connection set for 3/8", various filter cartridges, DF-8 diffusor, various filter granulates



AA Single Profi with connection set



Safety through brass thread inserts



ADP-0

Art.Nr.	90000196
Shortcode	ADP-0
Weight	approx. 1kg inc. wall mount
Height x Width x Length (width without fittings)	31 x 25,5 x 14 cm
Material	PP with brass inserts
Material O-Ring	NBR 70 Sh A
Connection thread	3/4" brass thread in/out
Flow rate	depends on filter cartridges
Packaging unit	6 pieces
Box	19 x 13 x 38 cm , 2 kg
Box PU	60 x 40 x 30 cm
Weight PU	9 kg

Customs number	8421 2100
EAN Number	4250188803399
Scope of delivery	Undersink-filter, wall mount, housing key
Max. flow rate housing	approx. 25 l/min.
Max. pressure	Max. 4 bar
Manufactured for	9 3/4" filter cartridges Carbonit®
Working temperature water	5 -50 °C
Min. operating pressure	approx. 1 bar, ideal 3-4 bar
A leak controller is included in the scope of delivery	
Restrictions of use	Use only cold water Not behind unpressurized boilers! Tested with 100.000 cycles from 1 to 10bar

AQUA AVANTI DOUBLE PROFI

Professional system for efficient water filtering

To redouble the life time of your main filter cartridge, please use a sediment filter at first stage.

Innovation: To increase the service time of your filter system, please use the optional diffusor with an anti lime scale granulate or p.e. an nitrate reducing granulate. It can be easily put in the Cartridges.

- Professional filter system made from polypropylene with high pressure stability.
- Use with carbon filters, further stages can alternatively have filter granulate for, for example, water softening (with optional diffusor)
- Secure installation as the inlet and outlet are equipped with integrated brass thread inserts.

Optional accessories:

AP-75 connection set for 3/8", various filter cartridges, DF-8 diffusor, various filter granulates



Usage with granulate as 2nd stage

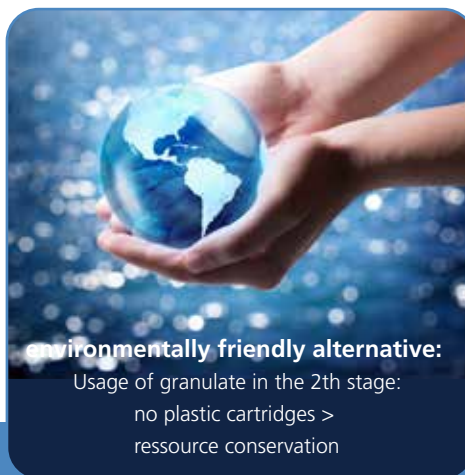

Environmentally friendly alternative:
Usage of granulate in the 2th stage:
no plastic cartridges >
ressource conservation

**AQUA AVANTI
optional with Diffusor**



ADP-2

Art. No.	90000172
Shortcode	ADP-2
Weight	approx. 1,95 kg inc. wall mount
Height x Width x Length (width without fittings)	31 x 25,5 x 14 cm
Material	PP with brass inserts
Material O-Ring	NBR 70 Sh A
Connection thread	3/4" brass thread in/out
Flow rate	depends on filter cartridges
Packaging Unit	3 pieces
Box	47 x 46 x 18 cm, 3,2 kg
Box PU	70 x 50 x 50 cm
Weight PU	approx. 6kg

Customs number	8421 2100
EAN number	4250188803412
Scope of delivery	Undersink-filter, wall mount, housing key
Max. flow rate housing	approx. 25 liter/min.
Max. Pressure	Max. 4 bar
Manufactured for	9 3/4" filter cartridges Carbonit®
Working temperature water	5 -50 °C
Min. operating pressure	approx. 1 bar, ideal 3-4 bar
A leak controller is included in the scope of delivery	
Restrictions of use	Use only cold water Not behind unpressurized boi- lers! Tested with 100.000 cycles from 1 to 10bar

AQUA AVANTI TRIPLE PROFI



Three stages water filter system

Ideal for requirements with heavily polluted water. First stage can be used p.e. for pre-filtering, second stage for granulates and third stage for filter cartridges. Professional filter system made from polypropylene with high pressure stability.

- Use with carbon filters, further stages can alternatively have filter granulate for, for example, water softening (with optional diffuser)
- Secure installation as the inlet and outlet are equipped with integrated brassthread inserts.

Optional accessories:

AP-75 connection set for 3/8", various filter cartridges, DF-8 diffuser, various filter granulates

with connection set



system head



ADP-3

Art. No.	90000173
Shortcode	ADP-3
Weight	approx. 2,85kg inc. wall mount
Height x Width x Length (width without fittings)	31 x 40 x 14 cm
Material	PP with brass inserts
Material O-Ring	NBR 70 Sh A
Connection thread	3/4" brass thread in/out
Flow rate	depends on filter cartridges
Packaging unit	3 pieces
Box	47 x 46 x 18 cm, 4,1 kg
Box PU	70 x 50 x 50 cm
Weight PU	approx. 9 kg

Customs number	8421 2100
EAN number	4250188803429
Scope of delivery	Undersink-filter, wall mount, housing key
Max. flow rate housing	approx. 25/liter min.
Max. pressure	max. 4 bar
Manufactured for	9 3/4" filter cartridges Carbonit®
Working temperature water	5-50 °C
Min. operating pressure	approx. 1 bar, ideal 3-4 bar
Restrictions of use	Use only cold water Not behind unpressurized boilers! Tested with 100.000 cycles from 1 to 10 bar

UNDERSINK FILTER



carbonit® DUO HPP
FILTER MADE IN GERMANY

2-way device with a parallel arrangement

As a 2-way cartridge device with a parallel arrangement with simultaneous flow of the cartridges for the following filtering tasks

Main applications:

For use as an under table filter for kitchens and bathrooms, as well as for commercial use. Water filtration within the kitchen for treated drinking water, even with high traces of bacteria, lead and copper. Well suited for making beverages, cooking water, etc.

DUO-HP Classic / 115DUOHPP1

Filtering the entire cold water from the main pipe Keeping in mind the possible flow rates:

- Classic DUO HP about 7 l / min
- DUO HP Puro about 12 l / min
- 2x NFP Premium D (0,7µm) - Classic
- 2x IFP Puro (0,15µm) - Puro

DUO-HP Küche / DUOHP-KÜ

Filtering drinking water or food consumption (D = 4 l / min)

- 2x NFP Premium (0,45µm)
- Diverting the existing cold water line

DUO-HP Basic P / DUOHP-BA

An Individual modification is possible for (parallel) filtering systems. The cartridges, depending on the filtering task can be specifically selected and ordered separately by the customer.

Examples: Diverting the existing cold water line (for separate drinking water) or divert to (Filter the complete water system) your existing water faucet.



DUO HPP

Art. No.	115DUOHPP1
Model	DUO HP Classic parallel
Shortcode	DUOHP-CL
EAN number	4024875143545

Art. No.	115DUOHPP4
Model	DUO HP Basic parallel
Shortcode	DUOHP-BA
EAN number	4250188803467

Art. No.	115DUOHPP5
Model	DUO HP Küche parallel
Shortcode	DUOHP-KÜ
EAN number	4250188803450

Flow rate Performance	DUO-HP classic: ca. 7 l/min DUO-HP: IFP ca. 12 l/min
Restrictions of use	Use only cold water Not behind unpressurized boilers!

UNDERSINK FILTER



Installation example

DUO HPS

2-way device with a seriell arrangement

All DUO-filter units are ready for installation under the sink and can be supplied fully equipped depending on the version.

DUO-HP Kalk / DUOHPS-KA

Used for the softening of drinking water, followed by the safe-filtering of bacteria. Flow about 1l / min (optimum softening) Please check the life quality of the lime cartridge. The chemical treatment is processed through the ion-exchanger – which actually withdraws the lime (total hardness) from the water. 2-way cartridge device is used for water treatment in serial within the kitchen or bathroom. DUO Lime is used when an additional reduction of water hardness is desired.

- 1x IKK/Reg.
- 1x NFP Premium
- Filtering the entire cold water from the main pipe

DUO-HP Spezial / DUOHPS-SP

For heavily contaminated water the 2-way cartridge device is used in serial (Pre-filter and main filter) within the kitchen or bathroom.

Suitable for highly polluted water such as iron particles. Flow approx. 2 l / min.

- 1x VFS 09/001
- 1x NFP Premium
- Filtering the entire cold water from the main pipe

DUO-HP Basic S / DUOHPS-BA

Individual requirement to (serial) filter system. The cartridge can be selected by the customer for the filtering task required and ordered separately.

Examples:

- Pre-filter in front of the activated carbon cartridge in order to protect them from rapid clogging
- adsorption increased by 2 serial activated carbon cartridges (Doubled contact time) without cartridges
- Filtering the entire cold water from the main pipe or even to recycle (the entire water system) to your existing faucet

DUO HPS

Art. No.	115DUOHPS2
Model	DUO Kalk seriell
Shortcode	DUOHPS-KA
EAN Number	4024875143576

Art. No.	115DUOHPS3
Model	DUO HP Spezial seriell
Shortcode	DUOHPS-SP
EAN number	4024875143583

Art. No.	115 DUO HPS4
Model	DUO HP Basic seriell
Shortcode	DUOHPS-BA
EAN Number	4250188803474

Height x Width x Length	30 x 28 x 15 cm without connections
Flow rate Performance	depends on the filter cartridge
Restrictions of use	Use only cold water Not behind unpressurized boilers!

UNDERSINK FILTER



carbonit[®]

FILTER MADE IN GERMANY

VARIO-HP

CLASSIC / COMFORT / BASIC / KITCHEN / UNIVERSAL



VARIO-HP Classic 120 VHP-BS1:

T-piece, shut-off globe valve, three pieces of stainless steel, flexible hose, threaded joint, wall bracket, water faucet, seals. A CARBONIT[®] Monoblock NFP Premium filter cartridge is included.

VARION-HP Basic 120 VHP-BS13:

Same as Vario Küche but no filter cartridge included VARIO-HP Comfort: as with VARIO-HP Classic, but with rapid coupler on the filter housing. A CARBONIT[®] IFP Puro filter cartridge is included.

VARIO-HP Universal 120 VHP-BS4:

shut-off globe valve, two pieces of stainless steel flexible hose, threaded joint, wall bracket, rapid coupler, seals. A CARBONIT[®] IFP Puro filter cartridge is included.

VARIO-HP Kitchen 120 VHP-BS14:

Same as Vario Classic but mit rapid coupler, without faucet.

VARIO-HP Comfort 120 VHP-BS2:

Same as Vario Classic but mit rapid coupler and filter cartridge Carbonit[®] Monoblock IFP Puro.



Installation: VARIO-HP Universal



Installation: VARIO-HP Küche



Installation: VARIO-HP Classic

VARIO HP

Art.No.	120VHP-BS1
Shortcode	VHP-CL (Classic)
Weight	2,4 kg net
Material	pressure resistant housing
Connection thread	3/8"
Flow rate	VARIO classic: approx. 120 l/h
Packaging unit	4 pieces
Box LxBxH	390 x 225 x 220 mm
Box PU	800 x 450 x 250 mm
Weight PU	12 kg

Customs number	84212100
EAN number	4024875900322
Scope of delivery	filter housing, faucet, NFP filter-cartridge + Installations material
Suitable for	9 3/4" filter cartridge
Min. operating pressure	approx. 1 bar
Restrictions of use	Use only cold water Not behind unpressurized boilers!

SHOWER FILTER SF-89

The wellness shower filter

Take a shower into a new experience. The water feels better on your skin and smells refreshing. The new shower Filter SF-89 in top design, is made of high quality chromed ABS material. The installation and replacement of the filter cartridge can be done very quickly and easily. The standard cartridge filter contains carbon granulate to eliminate the smell of chlorine with a life expectancy of ca. 3 months.

Optional cartridge are also available. (See below)

- FC-88 with KALKO INNOVA lime scale protection, carbon, and EM pipes
- FC-89 with carbon, mountain crystal, amethyst, rose quartz
- FC-91 with KDF filling and carbon
- FC-99 Standardfilter

Adapter:

The shower filter is either connected directly to the shower unit or between the unit and shower head. An alternative option will be made available in the near future to offer a short hose adapter for an easier, accessible connection for the eventuality that a connection is too close to the wall for a suitable fit.

45° Corner valve (Angled)

Most shower valves are mounted in close proximity to the wall. To easily mount the SF-89 you can order the angled adapter valve. Material: Chrome-plated brass. Fitting 1/2" F x 1/2" "

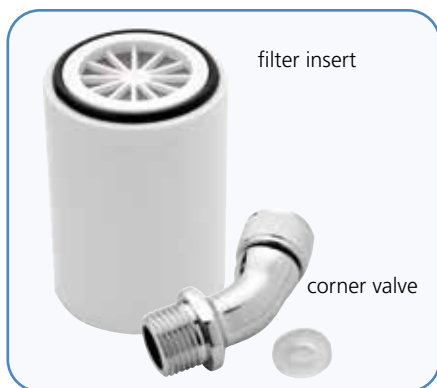

SF-89

Art.No.	chrome-plated: 90000056 white: 90000170
Shortcode	SF-89 chrome-plated t - SF-90 white
Weight	285g without packaging
Length - diameter	approx. 9,5x7 cm
Material	ABS
Connection thread:	1/2" IG - 1/2" AG
Flow rate	3,7 l/min
Packaging unit	1 piece

Customs number	84219900
EAN number	SF-89 - 4250188803757 SF-90 - 4250188803719
Scope of delivery	Shower filter housing
Operating pressure	3,5 bar
Manufactured for	Showers
working water temperature	4-60 °C
Min. operating pressure	1 bar

LEAK CONTROLLER LC

for 1/4", 3/8" and 1/2" connections



The leak controller LC switches off the inflow of the water line after the LC if water leaks. A small tissue tablet is integrated, which soaks up with water and then activates the valve of the LC and interrupts the flow of water. The tissue tablet can be exchanged as often as required so that the LC can be used again and again with a new tissue tablet after a leak.

Installation:

Make sure that the hose of your filter system fits the size of the LC. The LC is available with 1/4", 3/8" and 1/2" connections. The LC is installed in the water supply before your filter system. The inlet hose must be opened (cut through) and then the inlet hose is inserted into the inlet of the LC and the side of the hose in the direction of the filter system is inserted into the outlet side of the LC. Please make sure to cut the hose straight (do not use pliers, but a sharp knife).

The LC should be checked and cleaned of dirt every 6 months. The LC should be replaced annually to ensure maximum safety. Please check the snap function of the valve by lifting the cap under which the tissue tablet is located. The valve should then snap immediately. It is best to check this function several times. If it is stiff, use some silicone oil or, if in doubt, replace the LC.

LC

Aet.No.	LC 1/4": 90000574 LC 3/8": 90000573 LC 1/2": 90000575	Customs number	8421990
Shortcode	LC 1/4", LC 3/8", LC 1/2"	EAN number	LC 1/4": 4250188804068 LC 3/8": 4250188804051 LC 1/2": 4250188804075
Weight	approx. 62g	Main location	On filter systems under the sink, reverse osmosis systems, water dispensers, etc.
Dimensions	4,2 x 11,7 x 5,2 cm (BxLxH)		
Material	Nylon		

FAUCETS



PRIME INVENTIONS FAUCETS

Our kitchen faucets are a useful addition to your undersink filter system.

Choose from 2 types:

1. Cold water filter water faucet

The classic filter faucet with one inlet exclusively for filtered water. Because only filtered water passes through it, it's first choice for filtering bacteria for example.

2. 3-way faucet

Faucets with up to 3 inlets for cold, warm and filtered water. The filtered water flows separately from normal tap water with sufficient space between. The filtered water also has its own separate lever in addition to the lever for cold/ hot water.

High-quality materials

Our faucets are exclusively produced from high-quality materials such as stainless steel or brass. Faucet adapters for our water-whirlers and osmose systems are also available.

Model	Shortcode	Material	System	Features
F-28	F-28	stainless steel	3-way	3-way stainless steel design-faucet
F-29 Tina	F-29	stainless steel	1-way	Stainless steel design-faucet
F-19S Nena	F-19S	chrome plated brass	1-way	Slim modern design faucet
WS-8	WS-8	plastic / chrome plated	1-way	Elegant, affordable faucet with a free outlet
WS-8P	WS-8P	plastic / chrome plated	1-way	Shapely, inexpensive faucet with aerator
WS-6	WS-6	chrome plated brass	3-way	Stable 3-way faucet with separate valve at the outlet end and separate outlet for filter water
WS-7	WS-7	chrome plated brass	3-way	with separate valve on the tap and separate outlet for filtered water withdrawal

F-28 TRIPLE

3-way stainless steel design-faucet



The F28 "Triple" Stainless steel faucet is designed with a three-way valve beneficial for cold, warm water and filtered water. The stainless steel cage has a waterproof ceramic seal-ant and the water is delivered through a mixed seal internal aerator. The lever on the right side regulates the unfiltered water hot / cold. The two water pipes for service water and filter water are also internally separated and lead into the respective outlet for filter water (smaller) or service water (large). The faucet is characterized by integrated internal aerators and 360 ° rotatable outlet pipe.

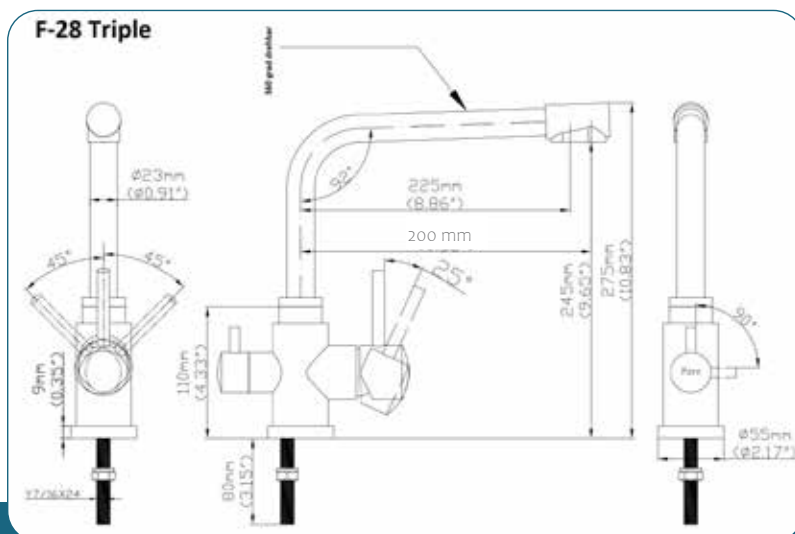

F-28

Art.No.	90000038
Shortcode	F-28
Material	stainless steel
Hose	flexible hose
Traversable	360°
Weight	1,85 kg without packaging 2,5 kg with packaging
Overall height	approx. 35,5 cm
Height from bottom to pebble	approx. 27,5 cm
Discharge of the discharge pipe	approx. 20 cm

Assembly on worktop	Max. plate thickness
Diameter	approx. 5,7 cm
Bore diameter for worktop	approx. 35 mm
Box (BxHxT)	42,5 x 36,5 x 6 cm
EAN Number	4250188805836
Scope of delivery	F-28, 2 flexible hose, manual
Connection	3/8"
Main location	Kitchen

F-29 TINA

1-way design-faucet



The F-29 Tina Stainless steel faucet is ideal for the modern kitchen or even for the stylish bathroom. The faucet can easily be mounted on to thick Marble worktops because of the 8 cm connection pipe. With its extra thick spout the faucet can easily be swivelled on its own axis by 360°.

The water spout is integrated with a faucet aerator and has a threaded M22x1 thread which is ready to be fitted with the water whirler

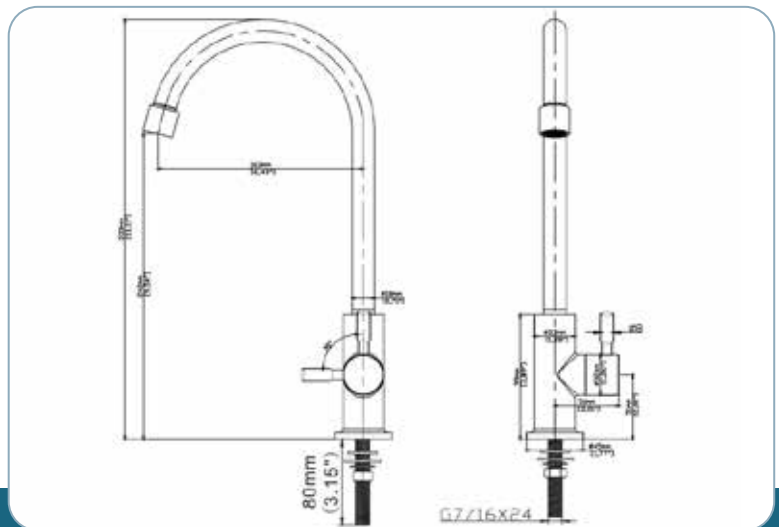

F-29

Art.No.	88805829
Shortcode	F-29
Material	Stainless steel
Hose	flexible hose
Traversable	360°
Weight	approx. 600 g without packaging
Overall height	approx. 41,3 cm
Height from bottom to pebble	approx. 24,2 cm
Discharge of the discharge pipe	approx. 16,3 cm

Assembly on worktop	approx. 7cm
Bore diameter for worktop	12mm
EAN Number	4250188805829
Connection	3/8"
Main location	Kitchen

FAUCETS

F-19 S



NENA

The new design filter water faucet F-19S fits ideal to the CARBONIT® Vario/Duo or Prime Inventions Pure under sink water filter. It is made from brass chromed (NSF tested) and has a 360 degree free moving faucet pipe and an aerator with thread. It is ready for connection with water whirlers with optional available adapter AD-21C made also from chromed brass.

Art.No.	90000297
Shortcode	F-19S
Material	chrome plated brass (NSF)
Traversable	360°
Weight	400 g
Overall height	29 cm (middle bend)
Height from bottom to pebble	18 cm
Discharge of the discharge pipe	ca. 15,5 cm
EAN Number	4250188800787
Bore diameter for worktop	approx. 10,24 cm
Box (LxBxH)	37 x 16 x 3,5 cm
Scope of delivery	F-19
Connection	3/8" AG with adapter
Main location	Kitchen, bathroom

WS-8 / WS-8P

Art.No.	WS-8 = 120VAR-WS8 WS-8P = 120 VAR-WS8P
Shortcode	WS-8 WS-8P
Material	Plastic / chrome plated
Traversable	360°
Weight	330 g without packaging
Overall height	27 cm
Height from bottom to pebble	approx. 21 cm
Discharge of the discharge pipe	approx. 12 cm
Assembly on worktop	58 mm max. worktop
Bore diameter for worktop	approx. 11,5 cm
Box (LxBxH)	32 x 14 x 3,5 cm
EAN Number	WS-8 = 4024875145808 WS-8P = 4024875172064
Scope of delivery	WS-8 WS-8P with aerator
Connection	3/8" AG with included adapter
Main location	Kitchen

WS-8 Faucet

An elegant and an affordable faucet

WS-8P Faucet

Like WS-8 but with aerator (f.e. for adaption with an waterwhirler)



FAUCETS



WS-6

Exclusive 3-way tap for cold, warm and filtered water with a changeover valve on the tap end and separate discharge for filtered water.

AD-30 VA Adapter

for assembling between Eggy Whirler or AW Piccolo and water faucet (WS6 CARBONIT®)
Only available with Water whirler.



WS-6

Art.No.	120 VAR-WS6
Shortcode	WS-6
Material	chrome plated brass
Traversable	360°
Weight	330 g without packaging
Overall height	approx. 21 cm
Height from bottom to pebble	approx. 19,5 cm
Discharge of the discharge pipe	approx. 26,5 cm
Assembly on worktop	55 mm
Bore diameter for worktop	approx. 35 mm
Box (LxBxH)	44 x 8 x 19 cm
EAN Number	4024875143699
Scope of delivery	WS-6, Adapter, 3x connection hoses
Connection	3/8"
Main location	Kitchen

WS-7

Art.No.	120 VAR-WS7
Shortcode	WS-7
Material	chrome plated brass
Traversable	360°
Weight	2,9 kg without packaging
Overall height	approx. 31,5 cm
Height from bottom to pebble	approx. 29,7 cm
Assembly on worktop	max. 75 mm
Bore diameter for worktop	approx. 34 mm
Box (LxBxH)	450 x 70 x 270 mm
EAN Number	4024875143705
Scope of delivery	WS-7, Adapter, 3 connection hoses, manual
Connection	3/8"
Main location	Kitchen



WS-7

Shapely 3-way tap for cold, warm and filtered water with separate valve on the tap and separate discharge for the extraction of filtered water..

AD-29 VA Adapter

for assembling between AW Piccolo and water faucet (WS7 CARBONIT®)
Only available with Water whirler.





BELLIMA®

The beverage water fan



The Bellima® Water Fan increases the joy of drinking tea or of other hot beverages

- improves the aroma of tea and coffee
- avoids cloudiness or film in tea
- reduces water hardness and avoids limescale build-up
- reduces heavy metal particles (e.g. iron, zinc, lead and copper from house installations)
- is ph-neutral and offers the precious potassium
- single use – no bacterial contamination
- is made of renewable raw materials in a non-polluting way and completely produced in Germany
- removes typical taste of tap water when used for cold drinking water
- can be disposed with waste paper or organic waste
- with its handy size it can also offer familiar water-quality on journeys into other countries (e.g. eliminates chlorine taste from water)

Just place the Bellima fan directly into the kettle and allow to boil. It's as simple as that. Jug filters can harbour germs and may also contain silver as an anti-bacterial agent. The Bellima fan is single-use, so there are no bacteria, and there is no need for antibacterial agents. The Bellima fan is an entirely natural, environmentally friendly product, made from sustainable materials (wood/cellulose): after use, simply recycle as paper or compost.

BELLIMA

Art.No.	88850012
Shortcode	BL-30
Material	Coated cellulose
Weight	75g
Sales packaging for dealer	10,5 x 8,8 x 2,5 cm
Content sales packaging	30 pieces
Packaging unit	10 pieces
Box PU	approx. 12 x 11 x 27cm
EAN Number	5015005850012
Main location	Water cooker or kettle

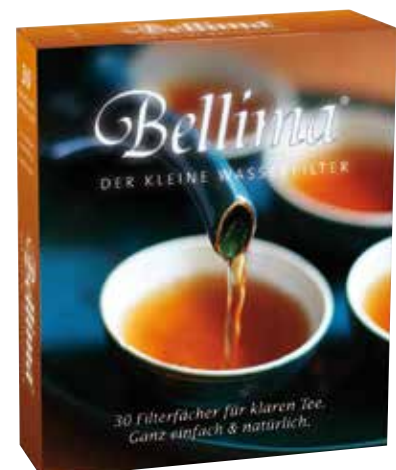

WATERWHIRLER



WATERWHIRLER

Our drinking water usually lacks that whirling movement. In water pipes the water is held in motion by the pressure of the water pipe and stagnates in some pipes. The Water also reacts to external influences such as electrosmog. The Prime Inventions aquawhirlers imitate the natural whirling of the water as found in rivers and waterfalls. All that is needed to drive it is the water pipe pressure. The specially designed whirler unit whirls the water in a small space in the same way that it would beif flowing through a river or stream. The water immediately tastes fresher and more natural after the whirling.

Benefits of our aquawhirlers

- Your tap water will taste milder and fresher,
- Almost as if from a natural source
- Your tap water will become more finely porous
- The water will gain more oxygen
- The CO² in the water will be reduced due to the whirling and thus more easily digestible
- Prepared meals and drinks can be made to taste better and more natural thanks to the use of Prime Inventions aquawhirlers
- You will save water because the water surface on the resultant vortex of water will be enlarged
- The Aquawhirler AW-888 is a stimulating shower spray that will make you feel like you're under a waterfall
- The additionally available EM ceramic pipes and/or stainless steel mixes will help you make your own personal well-being water
- Smooth adjustment of water flow rate possible (AW-888, AW-112 and WE-888 models)

All aquawhirlers (apart form the AW Mega) are supplied in an environmentally-friendly wooden box which will be sure to find a use in your home afterwards.



Model	Shortcode	Adjustable water flow	Integration chamber	Features
Aquawhirler	AW-888	yes	yes	The classic whirler with adjustable waterflow
Eggy whirler	WE-888	yes	yes	The archtype whirler with adjustable waterflow
Aquawhirler Inline	AW-26	-	yes	For installation under the sink
Aquawhirler Mega	AW-9000	-	yes	The ideal waterwhirler for usage in residential houses up to 14 Apartments, Industry, Agriculture a.s.o.
Aquawhirler Piccolo	AW-112	yes	yes	For use with 3-way faucets
Aquawhirler Perlo	AW-PERLO	-	-	Our smallest whirler with two different functions
Aquawhirler Inline	AW-9VA	-	yes	Invisible whirler, directly at the water inlet
Whirlators	diverse	-	-	Inexpensive series of waterwhirlers

AQUAWHIRLER AW-888



For adjustable water flow

Regulate the waterflow and whirl strength by turning the adjustment screw, accessible from the outside. This way regulating the water flow to the AW-888. The AW-888 is shipped with the max. possible flow amount.

Customers who prefer a straight water beam, can install the beam regulator. The water then leaves the whirler like on a normal tap and not in a bell shape. Internally the water is still whirled.

Waterwhirler with integrated gemstone chamber

Prime Inventions waterwhirler have a integrated gemstone chamber for energizing your drinking water.

Delivery in exclusive wooden box

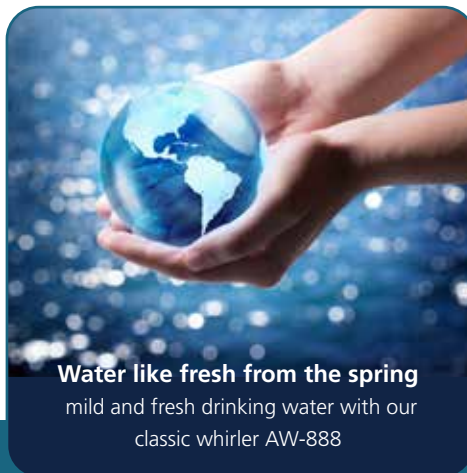

Water like fresh from the spring
mild and fresh drinking water with our classic whirler AW-888

twist-off cap



AW-888

Art.No.	88808882
Shortcode	AW-888
Weight	approx. 250g without packaging + adapter
Length	approx. 64mm
Diameter	approx. 50mm
Material housing	V4A stainless steel
Performance range	approx. 2 l/min ideal 4-6 l/min
Connection thread	M22x1 IG (M24x1 AG with the included adapter)
Packaging unit	1 piece

EAN Number	425018888877
Optional Energizing	Gemstones (E1) or Aquawhiler balls
Manufactured in	Germany
Main locations	directly at the faucet, ideal after water filtering
Scope of delivery	Whirler, Adapter, manual
Cleaning	AW-888 can be cleaned in the dishwasher. Please remove seals and gemstones before.
Min. operating pressure	approx. 1 bar, ideal 3,5 bar



EGGY WHIRLER

The archetype whirler

The construction of the arched type whirler assures a perfect vortex, even with low volumes of water which is ideal as a table water-filter with low water flux and the RO system (about 2 l of water per/min). The water flow or the vortex can be adjusted using a standard screwdriver from below through the water outlet opening itself.

Newly fitted filter cartridges allows for more flow at the beginning but will reduce after a while due to particles caught in the filter. This can be adjusted accordingly. The water flow has been set to maximum from the manufacturers.

Drinking water energized with Eggy Whirler

photographed on top of frozen water drops. Water drops of drinking water, energized with the Eggy Whirler, have been frozen and photographed digitally under the microscope. To compare with distilled water: there are very seldom crystalline shapes, messages, stars, etc. visible when we freeze distilled water drops.



Drinking water energized with Eggy Whirler



To compare:

Drinking water from Thun.

Orderd by:

Prime Inventions GmbH

Examined by:

Ernst F. Braun

CH-3664 Burgistein

Mai 2007 © - Probe Nr: 803

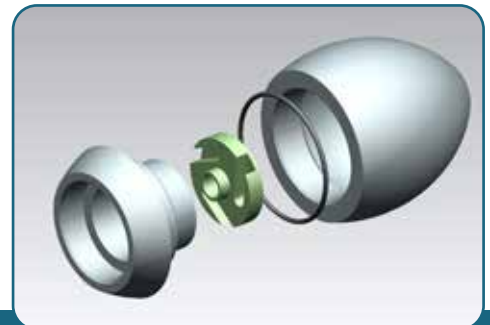

EGGY WHIRLER

Art.No.	88818898
Shortcode	WE-888
Weight	approx. 115g without packaging
Length	approx. 45mm without adaptor
Diameter	approx. 35mm
Material housing	V4A stainless steel
Performance range	Ideal 3 l/min, vortex from ca. 1,8 l/min
Connection thread	M22x1 IG (M24x1 AG with the included adapter)
Packaging unit	1 piece

EAN Number	4250188800107
Optional energizing	Gemstones (E1) or Aquawhirler balls
Manufactured in	Germany
Main locations	water filter, osmosis, caravan, yacht, hairdresser sink.
Scope of delivery	Whirler, adapter, manual
Cleaning	WE-888 can be cleaned in the dishwasher. Please remove seals and gemstones before.
Min. operating pressure	approx. 1 bar, ideal 3,5 bar

AQUAWHIRLER INLINE

V4A Whirler with Aquawhirler balls



The new AW-26 Aquawhirler is inserted for water whirling under the sink after the water filter or even in the shower. The housing is made of high quality V4A stainless steel. The whirling happens through the newest whirling technique of Prime Inventions with the help of the Aquawhirler balls - the whirling technique is patented: WO 2017/084711. Many small eddies are generated in the water by flowing around a number of small whirling depressions, specially milled in the glass balls. In nature, e.g. in rivers, the water also becomes turbulent by the flow around stones etc., from which a number of small vortices then also originate, which refresh the water. The AW-26 with Aquawhirler balls simulates this kind of natural whirling of the water and brings this directly into your water pipe.

Applications

- Connection ideally in the shower directly to 1/2" wall connections (with A4 Adaptation)
- behind the water filtration systems under the sink.
- Adaptation depending on the system connection - before the washing machine

Filling of the AW-26 whirler

A mixture of Aquawhirler balls.



Optional Adaptions:

A2: 2 pieces JohnGuest adapter 3/8" IG – 3/8" JG connection e.G. AquaAvanti Inline, or Osmosis systems with 3/8" pipes like AquaAvanti Osmo.

A3: 2 pieces adapter 3/8" AG – 1/4" JG connection for osmosis systems with 1/4" pipes.

A4: 1 piece nipple 1/2" IG – 1/2" IG from V4A to connect a shower pipe. Other AW-26 side to connect to 1/2" shower valve outlet at the wall.

A5: 2 piece nipple 1/2" - 3/4" to connect a washing machine

AQUAWHIRLER INLINE

Art.Nr.	88813626
Shortcode	AW-26
Weight	290 g
Length	11,6 cm
Diameter	2,5 cm
Material housing	V4A stainless steel
Min. flow rate	approx. 0,5 l/min
Max. flow rate	approx. 10 l/min
Connection thread	1/2" IG

Packaging unit	1 piece
EAN Number	4250188813626
Optional adaptions	see above
Manufactured in	Germany
Main locations	Kitchen, shower, washing machine
Scope of delivery	Delivery in a luxury wooden box, Whirler, wall mount, 160mm 3/8" - 3/8" IG flex hose, 2 adapter to 3/8" AG, 160mm 3/8" - 3/8" IG flex hose
Cleaning	AW-26 can be cleaned in the dishwasher. Please remove seals and balls before.
Min. operating pressure	1 bar

AQUAWHIRLER MEGA

the professional waterwhirler



The Aquawhirler Mega the ideal water whirler for use in residential buildings, residential complexes, up to 14 apartments, industry, hospitals, agriculture etc. The housing is made of V4A stainless steel (union nuts V2A with no water contact). By using various V4A stainless steel connection adapters, the device can be connected to 1", 1.5", 2" or 2.5" threads. The seals are made of high quality silicone. For industrial applications, chemically resistant sealing rings are optionally available. The whirling is generated by the new patent pending Aquawhirler balls.

The specially shaped surface of the Aquawhirler balls create thousands of small vortexes like as well found in nature for e. g. in rivers and give the water special properties. The Aquawhirler balls can be removed and cleaned if necessary. In addition, the whirling chamber is equipped with EM ceramics. We recommend the use of a water filter in front of the AW Mega. The Aquawhirler Mega the ideal water whirler for use in residential buildings, residential complexes, up to 14 apartments, industry, hospitals, agriculture to enhance the water structure and quality by our new invented water whirling principle.

Installation example



Scope of delivery, packed in a aluminum design box:

- Aquawhirler Mega housing including whirling elements (Aquawhirler balls) and EM ceramic, individual fillings on request
- Two matching connection adapters for the desired connection 1", 1.5", 2" or 2.5"
- 1 special key for screwing on the connection adapter
- 2 wall mounts stainless steel with hanger bolts stainless steel
- dimensions of packing box: (LxWxH) 450 x 320 x 175 mm, 2.4 kg box weight



Delivery in aluminum case

AQUAWHIRLER

Version	Shortc.	max. flow rate	Residential units	Art. No.	EAN Number
1" Connection-Version	AM-1	approx. 6.000 l/h	approx. 8 residential units	90000126	4250188806369
1,5" Connection-Version	AM-2	approx. 8.000 l/h	approx. 10 residential units	90000127	4250188806376
2" Connection-Version	AM-3	approx. 10.000 l/h	approx. 12 residential units	90000128	4250188806383
2,5" Connection-Version	AM-4	approx. 12.000 l/h	approx. 14 residential units	90000129	4250188806390

Weight	approx. 5,5 kg	Box	45 x 32 x 13,5 cm
Length	approx. 41cm	Weight with box	7,5 kg
Diameter	approx. 7 cm	Optional energizing	Aquawhirler balls, EM-Pipes
Material housing	V4A	Manufactured in	Germany
Flow rate	see above	Main location	Industry, residential houses, agriculture
Anschlussgewinde	see above	Mind. Max. working pressure	2 bar / 12 bar
Packaging unit	1 piece		

AQUAWHIRLER PICCOLO

Effective whirling even with low water flow



The AW Piccolo is completely made up of high-quality stainless steel, which complies with drinking water standards. When used with water with low PH levels (e.g. reverse osmosis water), there is no corrosion.

Additional energetisation:

The vortex chamber can optionally be fitted with a variety of energizing gemstones containing vitalizing corals & rock crystal/quartz. Prime Inventions offers an assortment of gemstones, such as the E1 collection, which is comprised of six different vitalizing gemstones. The construction of the vortex chamber assures a perfect vortex, even with low volumes of water which is ideal as a table water-filter with low water flux and the RO system (approx 1.3 l of water per/min). The water flow or the vortex can be adjusted using a standard screwdriver from below (after the aerator has been unscrewed) through the water outlet opening itself. Newly fitted filter cartridges allows for more flow at the beginning but will reduce after a while due to particles caught in the filter. This can be adjusted accordingly. The water flow has been set to maximum from the manufacturers.

The water outlet flow is straight; not a bell shape like with the Eggy Whirler. This means it does not squirt water sideways.

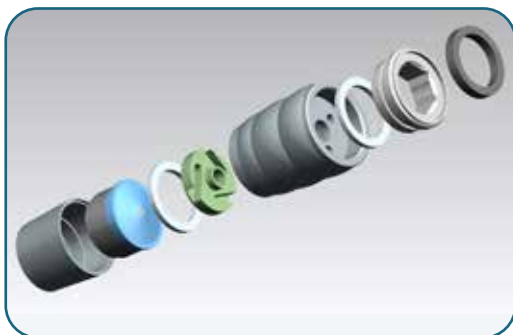

AW-112

Art.No.	88806529
Shortcode	AW-112
Weight	53 g
Length	4,8 cm
Diameter	2,7 cm
Material Housing	V4A stainless steel
Connection thread	M22x1 IG (M24x1 AG with the included adapter)
Packaging unit	1 piece
Whirling	from approx. 0,7 l/min

EAN Number	4250188800381
Optional energizing	E1 gemstone mix
Manufactured in	Germany
Main location	Faucet
scope of delivery	Whirler, adapter, manual, delivery in a luxury wooden box
Cleaning	AW-112 can be cleaned in the dishwasher. Please remove seals and balls before.
min. working pressure	ideal 3,5 bar - mind. 1 bar

AQUAWHIRLER PERLO



An innovation from Prime Inventions

The compact, mini Aquawhirler Perlo contains a reversible whirling element. You can thus choose whether the whirled water should come out as a vortex bell or jet. The Aquawhirler Perlo thus has 2 functions, firstly, the water "as a bell" option, just like with our Eggy Whirler, and, if you turn the Aquawhirler Mini whirling element inwards, you will get a straight water outlet, just like with the Piccolo.

The housing is made from high-quality V4A stainless steel and the whirling insert is made from plastic material suitable for use with drinking water. You can thus also replace the whirling insert individually. For reasons of hygiene, we recommend it ideally always be replaced at the same time as the filter cartridge change every 6 months. As the whirling element is made from a very small amount of plastic, its replacement is environmentally-friendly. You will save on the use of chemical agents which are otherwise necessary for cleaning and decalcifying with conventional jet regulators.



Whirling unit Aquawhirler Perlo



The easiest way to produce tasty spring water from your faucet



Whirling as a bell

AW PERLO

Art.No.	90000318
Shortcode	AW-PERLO
Weight	approx. 18 g
Length	without adapter 19,5 mm with standard adapter 30 mm adapter for 3way faucets 37 mm
Material Housing	cap V4A Edelstahl Whirling unit PET
Flow rate	up to approx. 10 l/min
Connection thread	M22x1 IG (M24x1 AG with the included adapter)

EAN Number	4250188801951
Optional connection	Optional variants for 3-way faucets WS-7 and WS-6 are available.
Main location	Faucet
Scope of delivery	Whirler (incl. whirling unit) adapter
Cleaning	AW-Perlo can be cleaned in the dishwasher
Change interval whirling unit	every 6 months recommended
Min. working pressure	ca. 1 bar ideal 3,5 bar
Spare parts	Whirling unit Aquawhirler Perlo ArtNr. 90000493, AW-PWE EAN 4250188804471

AQUAWHIRLER INLINE 9-VA



Direct connection to the water pipe

The perfect aquawhirler for all customers who cannot or do not want to connect an aquawhirler to the outlet faucet. The AquaWhirler Inline (AW-9VA) is structurally similar to the AW-26. Both are fitted in the water pipe after the under-sink filter and before the water faucet. The best position is directly at the entrance to the filter faucet. The housing of the AW-9VA is made from high-quality V4 stainless steel and already has a faucet adapter with UNS 7/16"-24 thread (standard in many water filter systems) delivery. It can be easily connected to faucets with a standard 3/8" thread without an adapter. On the inlet side there is a 3/8" external thread for standard flexible hoses.

The whirling takes place using the specially developed whirling insert (similar to the AW-Perlo). Directly after the whirling insert, a second insert has been integrated for water treatment media. This is usually filled with rose quartz, amethyst and rock crystal stones. It is possible to open it and insert your own filling. Both inserts can be removed. For reasons of hygiene, you should replace the whirling insert and the stainless steel chamber annually. Alternatively, the inserts can also be cleaned in the dishwasher (up to max. 70 degrees max. approx. 3 x)



**Whirler
AW-9VA**



**Spare part
Gemstone unit
AW9-EE**



**Spare part
Whirling unit
AW9-WE**

AW-9VAL

Art.No.	90000296
Shortcode	AW-9VA
Weight	137 g
Length	5,1 cm
Diameter	2,5 cm
Material housing	Stainless steel
Connection thread	3/8" AG – Output: 3/8" IG , enclosed adapter 3/8" AG – UNS 7/16"-24
Packaging unit	1 pieces
Whirling	from approx. 0,7 l/min
EAN Number	4250188803276
Main location	Water pipe kitchen
Scope of delivery	Whirler incl. Whirling- and gemstone unit, adapter, manual

Change interval whirling and gemstone unit:	every year recommended or after cleaning
Min. working pressure	ideal 3,5 bar - mind.1 bar

Spare parts	
Model	Whirling unit
Art.No.	90000494
Shortcode	AW9-WE
EAN Number	4250188804488
Model	Gemstone unit for E1
Art.Nr.	90000495
Shortcode	AW9-EE
EAN Number	4250188804495

WATERWHIRLER



Whirlator® WTE-241 VA

The Stainless steel Whirlator® WTC 241 VA for lavatory faucets in kitchen and bathroom, generates higher solubility in water for great tasting soft drinking water.

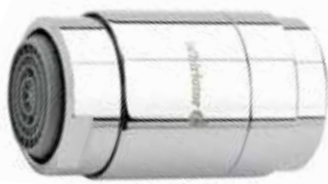

Whirlator® WTC-241

The Whirlator® WTC 241 for lavatory faucets in kitchen and bathroom, generates higher solubility in water for great tasting soft drinking water.



UT-380 for angle-valves

The Whirlator® UT 380 for easy mounting to any angle valve. Higher water solubility and reduced calcification for all design and non-standard fittings.

Art.No.	90000350
Shortcode	WTE 241
Weight	60g
Dimension	26mm x 40mm length
Capacity	ap. 900 Liter / h at 3,5 bar
Material	1.4404 VA POM Natur Hostaform C9021 with KTW - registration
Connection	M 24 x 1 und M 22 x 1 flat - sealing

Art.No.	70001000
Shortcode	WTC 241
Weight	60g
Dimension	26mm x 40mm length
Capacity	ap. 900 Liter / h at 3,5 bar
Material	MS Sanitary Standard POM Natur Hostaform C9021 with KTW - registration
Connection	M 24 x 1 und M 22 x 1 flat - sealing

Art.No.	70001003
Shortcode	UT-380
Weight	60g
Dimension	26mm x 47m length
Capacity	ap. 900 Liter / h at 3,5 bar
Material	MS Sanitary Standard POM Natur Hostaform C9021 with KTW - registration
Connection	G 3/8 Zoll - flat sealing



Whirlator® DAC-120 bathroom

The Whirlator® DAC 120 for your shower in the bathroom, generates higher solubility in water for great tasting soft drinking water. Technical devices are protected from rapid calcification. Air mixer , aerator stay looking neat longer, sustainable value retention



Whirlator® MA-340

The machine Whirlator® MA 340 increases the water solubility and supports the cleansing processes in washing machines and dishwashers. In addition up to 80% lime deposits can be reduced, saving on detergent.



Whirlator® EWY

Plastic whirlator for reverse osmosis units, specially for sensible areas after ultrafiltration. Whirlator® EWY is also useful when using coffee machines.

Art.No.	70001001
Shortcode	DAC-120
Weight	75g
Dimension	26mm x 47m length
Capacity	ap. 550 Liter / h at 3,5 bar
Material	MS Sanitary Standard POM Hostaform C9021 with KTW - registration
Connection	G 1/2" - flat sealing

Art.No.	70001002
Shortcode	MA-340
Weight	75g
Dimension	32mm x 36mm length
Capacity	ap. 550 Liter / h at 3,5 bar
Material	MS Sanitary Standard POM Natur Hostaform C9021 with KTW - registration
Connection	G 3/4" - flat sealing

Art.No.	9044400
Shortcode	EWY-1/4" und EWY-3/8"
Weight	45g
Dimension	29mm x 70m length
Capacity	ap. 540 Liter / h at 3,5 bar
Material	POM Natur Hostaform C9021 with KTW - registration
Connection	John Guest 1/4 or 3/8"

WATERWHIRLER



Whirlator® HC-340

The classic Whirlator® for central water supply in a family home - for improved solvency and spring water standard.

Art.No.	70001005
Shortcode	HC-340
Weight	1600g
Dimension	50mm x 189mm length
Capacity	ap. 1.500 Liter / h at 3,5 bar
Material	MS Sanitary Standard POM Hostaform C9021 with KTW - registration
Connection	G 1" - flat sealing



Whirlator® KKS-18P

The classic Whirlator® for industrial applications - for improved solvency and lime / germ protection

Art.No.	9040500
Shortcode	KKS-18P
Weight	500g
Dimension	65mm x 120mm length
Capacity	ap. 1.800 Liter / h at 3,5 bar
Material	POM Natur Hostaform C9021 with KTW - registration.
Connection	G 1" - flat sealing



Whirlator® KKS-81

13 specially arranged vortex chambers swirl every water molecule, generate orderly structures with optimal limescale and germ protection, inexpensive investment around larger residential complexes or e.g. Protect smaller swimming pools and other things from germs and limescale.

Art.No.	9040600
Shortcode	KKS-81
Weight	1500g
Dimension	127mm x 157mm length
Capacity	ap. 10.000 Liter / h at 3,5 bar
Material	POM Natur Hostaform C9021 with KTW - registration
Connection	G 1 1/2" flat sealing



Whirlator® KKS-270

Currently the most powerful whirler from the Whirlator® range. Orderly structures provide optimal protection against limescale and germs. This whirler is an inexpensive investment for increasing yields in agriculture or for installation in the water circulation system in swimming pools.

Art.No.	90000349
Shortcode	KKS-270
Weight	1800g
Dimension	153mm x 285mm length
Capacity	ap. 27 till 35m ³
Material	MS Sanitary Standard POM Hostaform C9021 with KTW - registration
Connection	suitable for standard screw connection PVC 2 Zoll I x Dm I 75 mm / alternative Dm I 63 / 50 mm or G 2 1/2 Zoll A / suitable for B 75 fire hose / bayonet connection

EM-CERAMICS

EM™ EFFECTIVE MICROORGANISMS

EM is the short form for EM™ Effective Microorganisms, were discovered. by Prof. Teruo Higa, a professor at the University of Ryukyu University in Okinawa, Japan, in its specific composition 30 years ago.

EM ceramics and EM Gold® ceramics are produced in Japan and are based on Kibushi-Clay. After fermentation within several month with EM it is burnt on high temperature. The resonances will stay in the ceramic after burning. EM and EM Gold are available in different kinds for different usages.

Dr. Higa, professor at the University of Ryukyus on Okinawa (Japan) found in the 70s by chance that a combination of different microbes are able to influence a whole organic system in the way, that growing processes will be strengthened. The combination of these microbial strains he called EM™ Effective Microorganisms. He had made intensive researches of the impact of EM to plant growth. Over 20 years of experience in more than 120 countries the world shows, that EM™ Effective Microorganisms in the earth, water and also in the waste treatment can create very efficient processes. Instead of rotting it creates healthy processes.

MX1

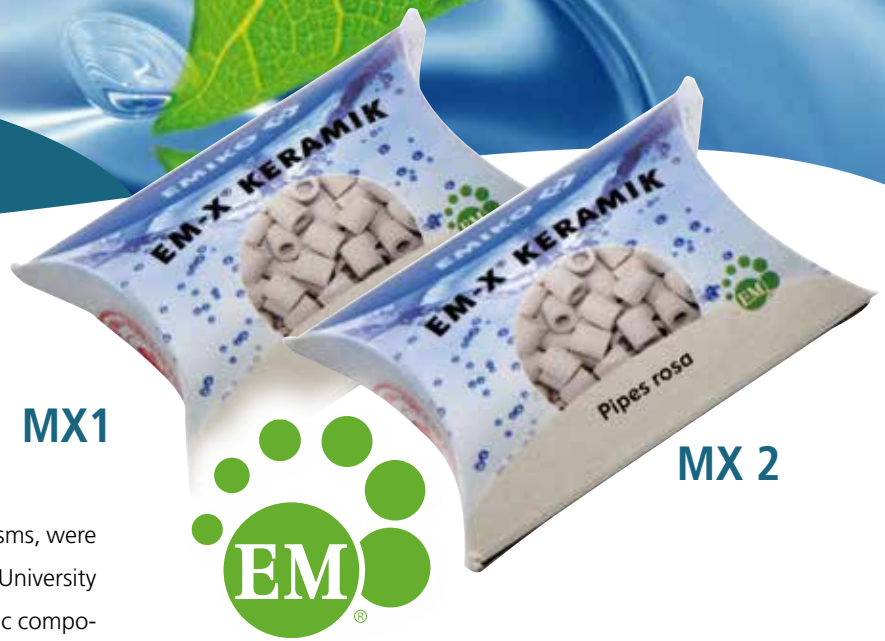

MX 2

EM Pipes grey 12 pcs. - MX 1

Info: reduces the water surface tension

To be used for: Water whirler like Aquawhiler, EggyWhirler with integrated filling chamber. Also good for water carafes, washing machines, dish washer, in the bath, to water plants and in the aquarium. Recommended usage time: up to 8 month.

EM Pipes rose 12 pcs. - MX 2

To be used for: Water whirler like Aquawhiler, Wirbelei with integrated filling chamber. Also good for water carafes, washing machines, dish washer, in the bath, to water plants and in the aquarium. The rose pipes will be burned at 1.000 degrees Celsius. Recommended usage time: up to 8 month.

Special clays, which are consists of millions of years old organic material of plants, are used for the production of the EM ceramic. EM consists of many different microorganisms, including aerobic and anaerobic ones, which were, according to earlier thinking, not supposed to be able to live in the same surrounding. They formed an extremely interesting population of life-supporting, antioxidative microorganisms.

Gemstone blend E1

For the Prime Inventions water whirler you can get the gemstone blend E1 which contains: quartz crystals, amethyst, cornelian, red jasper, orange calcid, rose quartz

QP-88 Quartz pearls

Quartz pearls for water enlivenment.

Optional for water whirler with gemstone chamber
7 pcs.



WATER VITALIS

Travel water filter bottles 750 ml / 1000 ml



Extremely light and practical travel water filter made from high-quality BPA-free silicon water containers and two filter stages.

The filter can be folded smaller to save space when travelling. Filtering of viruses, bacteria and pollutants through UF membrane filter and carbon capsule. The water filled into the bottle is pressed through the filter by the bottle's pressure. There is no need to suck on the bottle, and so the filtered water is also well-suited for preparing coffee or meals.

The Disruptor® filter medium has the ability to effectively remove a wide range of contaminants: bacteria / legionella, viruses, endotoxins, polysaccharides, colloids, drug residues and more pathogens - safer travel with Water Vitalis.

WATER VITALIS

Article	Art.No.	EAN-Number	Shortcode
Black 1.000ml	90000393	4250188803146	WV1SV
Orange 1.000ml	90000395	4250188803085	WV1OV
Green 1.000ml	90000394	4250188803139	WV1GV
Blue 1.000ml	90000396	4250188803092	WV1BV
Size 1.000 ml	290 X 80 mm, 270g		
Black 750ml	90000313	4250188802989	WV7SV
Orange 750ml	90000308	4250188803078	WV7OV
Green 750ml	90000304	4250188803054	WV7GV
Blue 750ml	90000306	4250188803061	WV7BV
Size 750ml	290 X 80mm, 230g		

Material	Silicone BPA free, PP Filter unit
Flowrate per minute	approx. 200ml
Filter units	Disruptor®
Filter changing interval	max. 260l
Performance	Bacteria 99.9%, viruses, chlorine, other pollutants
Usage restrictions	Drinking water 1-60 Grad C (no sea water, no industry water)
Box (HxBxT) Weight	25,2 cm x 7,9 cm x 7,9 cm, 240g (750ml) 28,5 cm x 8,7cm x 8,7 cm, 295g (1.000ml)
Packaging unit	4/8/12

THIS IS HOW WATER VITALIS WORKS:

Three simple steps to filtering water on the go - our filter makes your trip safer



Step 1 FILL

Fill the bottle with unfiltered water.



Step 2 CLOSE

Put the filter with light pressure into the filter head. Close the bottle.



Step 3 DRINK

Enjoy the filtered and pure water directly from the filter bottle - worldwide.



ADVANTAGES:

- Water filtration all over the world
- Effective against bacteria, viruses, chemicals, heavy metals
- Quick and easy - fill, squeeze, drink
- The ultimate virus protection
- No batteries, no chemicals required
- No suction necessary
- Easy filter change
- Can be folded up to save space
- Chemical-free water filtration
- available in 4 trendy colors

WATERVITALIS

Replacement filter cartridge



The WaterVitalis virus filter is used as a replacement filter cartridge for WaterVitalis filter water bottles.

The Disruptor® filter medium has the ability to effectively remove a wide range of contaminants: bacteria / legionella, viruses, endotoxins, polysaccharides, colloids, drug residues and other pathogens - travel safer with WaterVitalis.



**Easier Filter cartridge
change
by simple
Snap closure**

WATERVITALIS

Art.No.	90000551
Shortcode	WVEFV1
Weight	approx. 26 g
Length	approx. 75mm
Diameter	approx. 38mm
Material	Laminated carbon / cellulose Disruptor® Antimicrobial - Housing: food grade PP
Flowrate	1 Liter per min
Filter material certification	NSF/ANSI 42
Packaging unit PU	2 Stück 7 x 2 Stück

EAN Number	4250188803801
Box sizes	2-er Set – 21 x 4,5 x 4 7-er Set – 35 x 25 x 4,5
Change interval Filter inserts	after max. 260 liter
Connection	Double O-ring plug closure
Usage performance	150-260 liters depending on Degree of pollution of the Water
Usage restrictions	Drinking water 1-60 Grad C (no sea water, no industry water)



OSMOSIS

REVERSE OSMOSIS FROM PRIME INVENTIONS

How does reverse osmosis work?

In a reverse osmosis system, the tap water is pressed against a special membrane. This is only permeable in one direction.

Tiny passages of only 0.0001 micron (!) allows only the water molecules and not the other molecules in the water to pass through the membrane. While the non-permeable particles are retained and flushed out of the system via the drain, almost completely clean water exists the other side of the membrane.

This natural type of water filtration does not require any chemicals or electricity, but is based solely on the pressure of the water pipe.

Why reverse you should use reverse osmosis from Prime Inventions?

- Save money!
- Save the environment
- Your „airbag“ for the kitchen
- No more carrying heavy beverage crates
- Development and assembling of the device in Germany, with competent support!
- Four stage reverse osmosis device with new „twister- system“ to be built in under the sink.
- Carried out with sediment pre filter and active carbon pre filter to protect the high quality reverse osmosis module.
- Active carbon after filter for best taste
- With separate stainless steel tap
- Ratio of concentrate to pure water approx. 3.1 (can be different up to configuration for quality of incoming water)
- Simple installation and simplest change of colour coded filter elements
- Space saving lying installation in kitchen socket is possible!

Model	Best.No.	Performance l/day	Performance range	Tank volume	Features
AA OSMO	AA-196	85l	3-6 Bar, 2-36° C	12 Liter gross Usable volume approx. 8l	Reverse osmosis for private use
AA Osmo Profiline	AA-288	till 245l	3-6 Bar, 2-36° C	till 1.000 Liter	Ideal for gastronomy and industry

OSMOSIS

 4 Stage reverse osmosis unit - developed and produced in Germany



AA OSMO WITH EM CERAMICS

Tasty water with AA Osmo

We need around five litres of the best drinking water per person per day. Today many households drink bottled water, because they don't like the taste of the tap water. An expensive, uncomfortable and ecologically questionable solution, which is a burden to the environment due to transport and packaging. However, almost every household has tap water available which is excellently suited as a raw material for further processing. Our water filters, the AquaAvanti Osmo series, provide you with your daily needed quantity of healthy, good tasting water, from your normal tap water. In that way, you can save several hundred Euros a year and also protect the environment. Free yourself once and for all from carrying heavy crates.

Additionally with the AquaAvanti Osmo you will receive your „airbag in the kitchen“. What ever disturbing or dangerous substances come out of your water pipes, your AquaAvanti Osmo reduces almost all substances contained in the water over several filtration stages, to a level where they are no longer disturbing.

The main effect is achieved by reverse osmosis. This procedure has been tried and tested for decades and is even used for desalting sea water. With its patented and hydraulically driven permeation pump, the AquaAvanti Osmo device saves a lot of water compared with normal reverse osmosis devices and at the same time uses no electricity.

AQUA AVANTI OSMO

Art.No.	88888000	EAN Number	425018888013
Shortcode	AA-196	Pollutant retention	Yes
Weight	9,1 kg	Bacteria retention	Yes
Dimension L x B x H	47 x 49 x 31 cm	Main location	Kitchen
Flow rate	2-3 l/min from tank	Scope of delivery	Umkehrosmosanlage mit Membran und Filterpatronen, Tank weiß m. Bruttovolumen 12 Liter, Wasserhahn aus Edelstahl, Montagezubehör
Performance	85 Liter / day	Min. working pressure	3 bar
Packaging unit	1 Stück	Restriction of use	only cold water - protect from frost
Box	48 x 31 x 47 cm		
Changing interval filter cartridges	6-12 months		

OSMOSIS



Your advantages

- Save money!
- Save environment
- Your „airbag“ for the kitchen
- No more carry heavy beverage trailer
- Development and assembling of the device in Germany, with competent support!
- Four stage reverse osmosis device with new „twister- system“ to be built in under the sink.
- Carried out with sediment pre filter and active carbon pre filter to protect the high quality reverse osmosis module.
- Active carbon after filter for best taste
- With separate stainless steel tap
- Ratio of concentrate to pure water approx. 3.1 (can be different up to configuration for quality of incoming water)
- Simple installation and simplest change of colour coded filter elements
- Space saving lying installation in kitchen socket is possible!

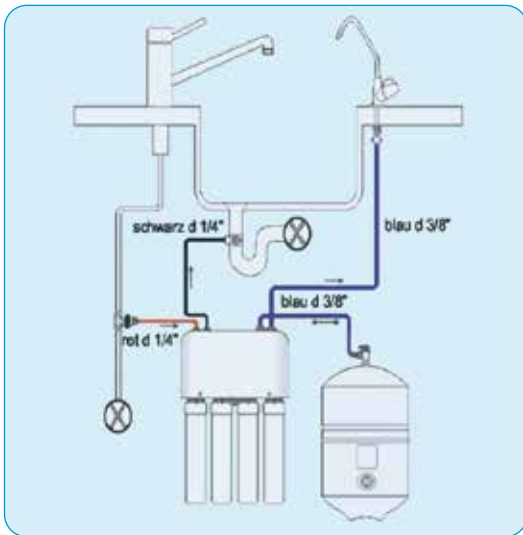

Accessories (optional)

- Water whirler EggyWhirler or AW-112 Picollo
- Various kinds of faucets like three way faucets
- AquaAvanti Calci, Okinawa calcium mineralisation

Optional: Mineralization

Prime Inventions recommends the mineralization level AA Calci Inline with original Okinawa calcium as the last level between tank and AA Osmo system. Since the water is also freed from minerals when passing through the AA Osmo, you should restore the natural structure of the water and add natural minerals afterwards.

The AA Calci Inline is easy to connect. Because of the quick filter change system, the cartridge replacement is done in seconds. Supplied with screws for wall mounting.

For daily enjoyment and ideal for:

- Preparing food and drinks
- For the production of untainted baby food
- For protection of your high quality household appliances
- For skin and face care
- No visible water stains on cleaned surfaces such as glass, mirrors etc.

AQUA AVANTI OSMO PROFILINE

Ideal for gastronomy and industry



Four-stage reverse osmosis system based to the AA Osmosystem for semi-professional use - for easy installation. 1 micron version and carbon block pre-filter to protect the highquality reverse osmosis module from free chlorine and other oxidants.

The filling of the RO tank is speeded up by the integrated electroless permeate pump. As a result, the AquaAvanti Osmo Profiline saves up to 85% of water compared to other pressure tank systems. Working range 3 - 6 bar, 2 - 36 ° C, manual flush valve for optional flushing of the diaphragm.

Control by hydraulic shut-off with re closing hysteresis - Concentrate to ultrapure water approx. 3: 1, daily production approx. 245 liters, The tank volume is adjusted depending on the application. The tanks are made of high quality polyethylene reinforced with glass fiber wrap and epoxy resin and are extremely resistant to wear. Inside is a new-generation air cell that completely separates water and air. The elasticity of the air cell is up to 600%. The tanks are seamless constructions with low weight, suitable for drinking water up to max. 50 ° C.

There is usually no maintenance required for the tanks.

AQUA AVANTI OSMO PROFILINE

Art-No.	88802392
Shortcode	AA-288
Weight	approx. 11 kg
Dimension L x B x H	47 x 49 x 40 cm
Flow rate/min	2-3 l/min from Tank
Performance	245 liter / day
Material	Polyethylen with glass fiber winding and epoxy resin
Concentrate / ultrapure water	ca. 3:1
Changing interval cartridges	ca. 6-12 Monate

EAN Number	4250188802392
Pollutant retention	yes
Bacteria retention	yes
Main location	Gastronomy and industry
Scope of delivery	Reverse osmosis with mebrane and filter cartridges - a tank and a faucet is not included. It can be choosed individually
Min. working pressure	mind. 3 bar
Restriction of usage	only cold water - protect from frost

OSMOSIS

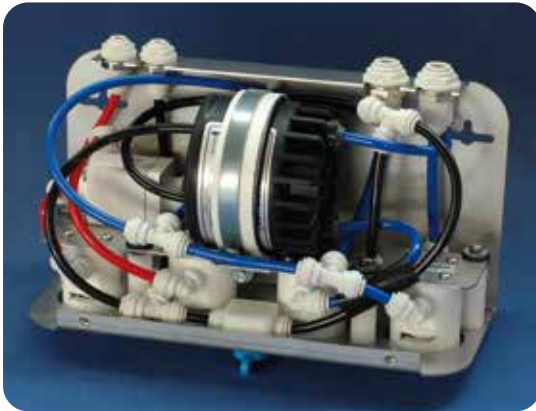

Inside view AA OSMO Profiline



- 1st pre-filter (red)
- 2nd pre-filter (yellow)
- 3rd membrane (green)
- 4th Aftertreatment filter (blue)

STRUCTURE PROFILINE

Water connection

Through a permanent connection to the cold water pipe.

1. pre-filter

sediment filter 1 micron for pre-separation of fine particles, which must be kept away from the membrane.

Change interval: every 6 - 12 months

2. Prefilter

Carbon block filter to protect the membrane from chlorine and others Oxidants.

Change interval: every 6 - 12 months

3. Membrane

Membrane 100 GPD with EM ceramic. Pore size about 1/10000 microns, reduces dissolved substances.

Change interval: approx. Every two to three years.

4. Aftertreatment Filter

Activated charcoal filter with EM ceramic to improve taste and reduce volatile chemicals that could pass through the membrane.

Change interval: every 6 - 12 months

Type	Ø	Height	Connection höhe	Connection (mm)	Pressure max.	Weight kg
WM 60 L	410	680	47	1"	8,5	7,0
WM 75 L	410	820	47	1"	8,5	9,0
WM 120 L	410	1130	47	1"	8,5	11,0
WM 150 L	410	1450	47	1"	8,5	14,0
WM 180 L	550	1050	56	1 1/4"	8,5	17,0
WM 235 L	620	1060	56	1 1/4"	8,5	23,0
WM 330 L	620	1410	56	1 1/4"	8,5	29,0
WM 450 L	620	1840	56	1 1/4"	9,0	42,0
WM 600 L	770	1700	150	2"	9,0	76,0
WM 750 L	770	2040	150	2"	9,0	89,0
WM 1000 L	920	2100	200	2"	9,0	117,0

WATER-SOFTENING

THE BENEFITS OF WATER-SOFTENING

1. Cost-saving

Dissolved lime adheres especially to hot water pipes and household devices operated with warm water such as dishwashers, coffee machines, and washing machines etc. Higher energy requirement due to deposits on the heating elements in the devices. This leads to higher energy requirement in the devices. Deposits only 1 mm in size can already lead to up to a 10% higher energy requirement.

2. Avoidance of pipe and water damage

Limescale deposits slowly lead to pipes becoming blocked. Subsequently, this results in high costs for replacing or clearing the pipes, which can be avoided by using a softening system.

3. Effect on skin, hair and laundry surfaces

Enjoy soft hands, shining hair and soft laundry. After softening, your showers, glass surfaces, bathtubs and sinks will be free from those limescale marks which are so difficult to remove. You will save on detergent and have cleaner clothes which will also better retain their softness and bright colors.

HOW TO CREATE LIMESCALE PROTECTION

Prime Inventions offers two limescale protection solutions with essentially two different operating principles.

1. The so-called ion exchange process to soften water
2. The Kalko Innova procedure which, via a special and long-lasting granulate, builds up a natural lime protection

For explanation, see Kalko Innova below - page 60

Ion exchange procedure

This has been a tried-and-tested water-softening process for decades. And this is how it works: Normal tap water contains so-called hardness formers such as calcium (Ca^{2+})- and magnesium (Mg^{2+})-, which are responsible for the hard water. In the softening system, these hardness builders, which are present in ion form, are exchanged for harmless sodium ions (Na^{+}) while the water flows over the ion exchange resin beads (inside the system).

However, the exchange capacity of the ion exchange filling in the device for the hardeners is limited. After a certain amount of water has flowed through, the ion exchange resin is full and must be freed again, regenerated. The regeneration takes place with simple common salt which is dissolved as brine in the device. Our softening systems regularly carry out regeneration automatically. That means you don't have to worry about it. Only the refilling of salt tablets, so-called broxettes, every 3 months is necessary, which can be done in a very short time.



**SUITABLE
FILTER CARTRIDGES
FROM PAGE 87**

HOME AND WELL WATER FILTRATION SYSTEMS

Systems for water decalcification, nitrate filtration and pollutant removal can be found in this category.

AQUA FIDELO

The complete system from Prime Inventions. Aqua Fidelo is a water filter system for individual households, multiple residential units, and industrial applications. It can filter municipal water and well water.

Model	Height	Diameter head	Features
AQUA FIDELO 20"	615 mm	185 mm	Pre and post filtration, iron filtration and protection against lime scale
AQUA FIDELO 10"	343 mm	185 mm	Pre and post filtration, iron filtration and protection against lime scale

KALKO INNOVA

The limescale protection system from Prime Inventions. KALKO INNOVA uses a special granulate with a specially coded surface and works in accordance with the procedure which has become known as the TAC (Template Assisted Crystallization) procedure in the USA, thus providing long-term protection against limescale deposits.

Model	Shortcode	Features
KALKO INNOVA mini	KI-1	Usage in the coffee machine or kettle
KALKO INNOVA SP	KI-2	Usage in the dishing machine
KALKO INNOVA WP	KI-3	Usage in the washing machine
KALKO INNOVA classic	KI8 - KI24 - KI48	Usage at the main water supply
KALKO INNOVA Big Green	KI-BG	Usage at the main water supply

Other systems for anti-lime scale, nitrate filtration and well water filtration:

Model	Shortcode	Type	Flow rate	Features
NH-1 Kombianlage	NH-1	Nitrate filtering Anti-lime scale	2,4 m ³ /h DIN 19636	Nitrate filtration and anti-lime scale till max. 30°C
LEX plus 10 connect	SLP-*	Anti-lime scale	2,1 m ³ /h	Full automatic anti-limescale units - ion exchange process
LEX plus SL	SLPSL	Anti-lime scale	2,1 m ³ /h	Full automatic anti-limescale units - with leak control
Carbonit® Quadro	QUADRO*	Well water filtering	depends on filter cartridges	Filter unit for the main water supply

HOUSE AND WELL WATER FILTRATION

Aqua Fidelo - our complete system

Aqua Fidelo is a water filtration facility for individual houses, several accommodation units and for industrial purposes. Both town water and well water can be filtered. For the filtration of well water we recommend a water analysis first in order to optimise the installation (see water analysis below). The installation is available as anything from one up to four container units. This means that Aqua Fidelo can be installed on the ground to the filtration capacity required. Between 2 and 4 filtration levels are recommended depending on the water quality. Aqua Fidelo is available in 10" or 20" containers according to the amount of water to be filtered.

Water capacity per minute:

The water capacity of the sediment and carbon filter (10my) for the AA Fidelo 10 is about 20-25l/min and for AA Fidelo 20 about 40-50 l/min, depending on water pressure. For installations with iron filter cartridges, AF-4 and AF-5, the water flows through the bottleneck of the iron filter cartridge. The 20" iron filter cartridges have a water capacity of about 18l/min. We recommend the installation of two parallel iron filter cartridges and containers in order to achieve the water flow of the pre-filters. The 20" iron filtration unit (container with filtration cartridge and accessories) can be ordered using the order number AF-E-20. The 10" unit can be ordered under the order number AF-E-10.

Safety information:

Only suitable for use with cold water. Must be installed by a sanitation or heating expert! For reasons of safety, we recommend a water drain near the filter installation. Can only be installed with a pressure regulator set to a maximum of 4,5 bar and a back-flow inhibitor.

Water analysis

Prime Inventions suggests to make a water analysis before buying the products.

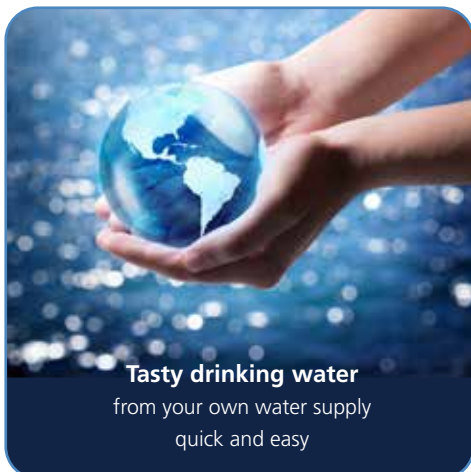

Tasty drinking water
from your own water supply
quick and easy



1 Unit



2 Units



3 Units

AQUA FIDELO 20"

Modular filter system

**NEW: AF-20" with 1,5" connection for more water flow.
One VA Adapter to 1" is included.**

household water filter container to be installed in the central water supply upon entry to the house after the water meter. Filter container and filter head with air valve are all made of food-safe, high-strength plastic.

The following comes as standard with each container:

- Wall bracket in white color with 4 stainless steel casing screws
- 2 casing nipples 1", V4AA casing key and 2 1" shut-off valves are also provided with every complete filter installation.

Empty weight	approx.. 3,4 kg
Height	approx. 615mm to the upper edge of the air valve
Diameter casing top	185 mm not including connecting nipple, with connecting nipples approx. 225mm
Packaging unit	1
Box	24 x 66 x 21 cm
Box PU 4 pieces	70 x 50 x 50 cm
Weight PU 4 pieces	18 kg
Restriction on use	only cold water - protect from frost

AQUA FIDELO 20"

Shortcode	Art.No.	EAN Number	Filtration	Scope of delivery
AF0-20 W	88801098	4250188801098		20" casing, V4A connection
AF1-20 W	88801036	42501888010136	prefiltration only	casing and sediment filter, 20"
AF1-20C W	88801043	4250188801043	without prefiltration	casing and carbon filter 10my , 20"
AF2-20 W	88801029	4250188801029	pre and post filtration	casing, sediment and carbon filter 20", 10my
AF3-20 W	88801104	4250188801104	pre and post filtration and protection against lime scale	casing, sediment and carbon filter 5my and lime scale protection cartridge 20", KALKO INNOVA
AF4-20 W	88801005	4250188801005	pre and post filtration, and iron filtration	casing, sediment and carbon filter 5my and iron filter cartridge 20", KALKO INNOVA
AF5-20 W	88800992	4250188800992	pre and post filtration, iron filtration and protection against lime scale	casing, sediment and carbon filter 5my, de-ironing cartridge and lime scale protection cartridge KALKO INNOVA 20"



1 Unit



2 Units



3 Units

AQUA FIDELO 10"

House and well water filter system

**NEW: AF-21" with 1,5" connection for more water flow.
One VA Adapter to 1" is included.**

household water filter container to be installed in the central water supply upon entry to the house after the water meter. Filter container and filter head with air valve are all made of food-safe, high-strength plastic..

The following comes as standard with each container:

- Wall bracket in white color with 4 stainless steel casing screws
- 2 casing nipples 1", V4A
- A casing key and 2 1" shut-off valves are also provided with every complete filter installation.

Empty weight	approx. 2,4 kg
Height	approx. 343 mm to the upper edge of the air valve
Diameter casing top	185 mm not including connecting nipple, with connecting nipples approx. 225mm
Packaging unit	1
Box	39,5 x 21,5 x 24 cm
Box PU 4 pieces	70 x 50 x 50 cm
Weight PU 4 pieces	16 kg
Restrictions on use	only cold water - protect from frost

AQUA FIDELO 10"

Shortcode	Art.No.	EAN Number	Filtration	Scope of delivery
AF0-10 W	88801081	4250188801081		10" casing
AF1-10 W	88800985	4250188800985	prefiltration only	casing and sediment filter, 10"
AF1-10C W	88801050	4250188801050	without prefiltration	casing and carbon filter 10my, 10"
AF2-10 W	88800978	4250188800978	pre and post filtration	casing, sediment and carbon filter 10my, 10"
AF3-10 W	88800961	4250188800961	pre and post filtration and protection against lime scale	casing, sediment and carbon filter 5my and lime scale protection cartridge 10", KALKO INNOVA
AF4-10 W	88800954	4250188800954	pre and post filtration, and iron filtration	casing, sediment and carbon filter 5my and iron filter cartridge 20", KALKO INNOVA
AF5-10 W	88800947	4250188800947	pre and post filtration, iron filtration and protection against lime scale	casing, sediment and carbon filter 5my, de-ironing cartridge and lime scale protection cartridge KALKO INNOVA 10"



KALKO INNOVA

Chemical free anti-lime scale

KALKO INNOVA uses specially formulated ceramic granules which mimic the natural bionic process of sea shell or coral, helping to create crystals that catch the lime scale in the water. Once it is in crystal form, the lime scale will not stick to pipes or surfaces, and when dried it's like a powder.

Once the crystal has reached a certain size it breaks away from the surface. The calcium ions in the water attach to these new crystals and in turn create new sub-micron sized calcium crystals that can then be carried along in the water. It takes only a few seconds for this formation to occur, and new seeding crystals continue to be created, repeating the process.

These new crystals are stable and will not attach to any surface, eliminating calcium deposit build up. KALKO INNOVA is a chemical free, salt-free anti-lime scale product, which is both natural and energy efficient. Chemical free anti lime lime scale is an approved biotechnology. From the year 2009 on, the technical standard - EU-Norm EN 1988-20 Ziff. 12,7 (technical standards for drinking water technology)- is determining that anti lime scale devices are approved for drinking water installations and to be state of the art.

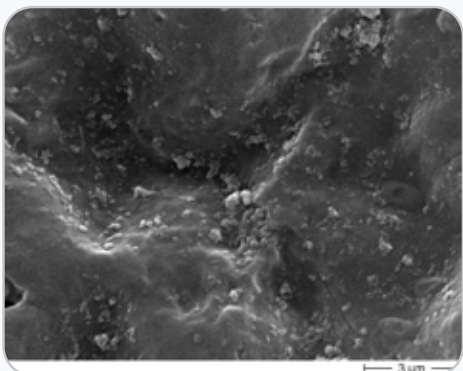

KALKO INNOVA
Growing of a seeding crystal

Advantages KALKO INNOVA

- Reducing of lime-scale
- No tight lime scale on dried surfaces
- Removing of the existing lime scale in pipes and equipments
- Creation of a protection layer in the pipes
- Chemical and salt-free
- The water stays chemically the same
- Maintenance free because it works with a catalyst
- Extend the life of your pipes and equipments
- Saving of energy

KALKO INNOVA



KALKO INNOVA MINI

- Usage in the coffee machine or kettle
- Protecting the machine and heating coil from lime scale
- Working good for minimum 6 month usage
- monthly disinfection of KALKO INNOVA mini is recommended (put the KALKO INNOVA mini for short time in min. 70° C hot water)



KALKO INNOVA SP

- Usage in the dishwasher
- Saving of detergent, liquid rinse and salt
- Good for aprox. 3 months or aprox. 40 dish washing sessions
- Protecting the machine and heating coil from lime scale



KALKO INNOVA WS

- Usage in the washing machine
- Saving of softener
- Less detergent needed
- Save energy and money by lowering your heating bills
- Help colors stay brighter and whites stay whiter
- Good for aprox. 3 months or aprox. 50 loads
- Protecting the machine and heating coil from lime scale

KALKO INNOVA BAGS

	KI MINI	KI SP	KI WS
Art.No.	88830012	88830098	88830081
Shortcode	KI-1	KI-2	KI-3
Weight	8 g	15 g	15 g
Durability	6 months	3 months	3 months
EAN Number	4250188830012	4250188830098	4250188830081
Main location	coffee machine, kettle	dishing mashine	washing machine
Packaging unit	1 piece	1 piece	1 piece



KALKO INNOVA CLASSIC-LINE

Chemical free anti-lime scale

AquaKalko Classic-Line products are made for the main water supply from 8 l/min. to 48 l/min water flow. The big advantage are the easy changeable catalyst granulate cartridges which should be changed after approx. 3-5 years.

The AquaKalko product line for professional use of higher water volume up to 18qm per hour is available on request. Please specify water quality and volume to receive an offer.

KALKO INNOVA CLASSIC-LINE



REPLACEMENT CARTRIDGES

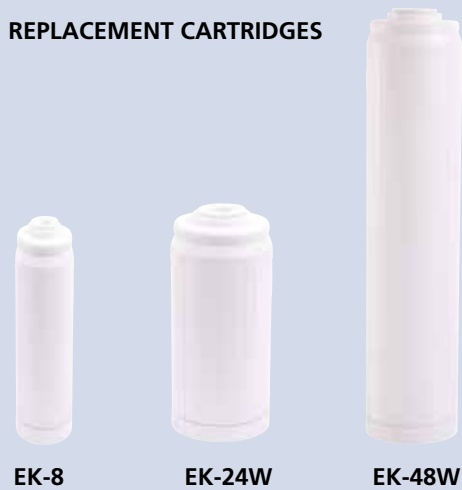

KALKO INNOVA CLASSIC

Shortcode	KI-8	KI-24W	KI -48W
Art.No.	88830067	88816160	88816177
EAN Number	4250188830067	4250188816160	4250188816177
Dimension	10"	10"	20"
Packaging unit	1 piece	1 piece	1 piece
Performance	8 l/min	24 l/min	48 l/min
Residential units	1 Room	1 apartment	2 apartments
Connection	3/8"	1"	1"



KALKO INNOVA BIGGREEN

Innovative limescale protection and filtration

Protect your water in the gastronomy sector, industry, and at home

KI Big Green offers environmentally-friendly water treatment and filtration. The device protects your water pipes and equipment from limescale deposits. The method is based on TAC (Template Assisted Crystallization) treatment, treating your water without using chemicals or salt. The KI Big Green is not only compact, but, through its revolutionary, two-stage high-flow carbon block filtration procedure, can also reduce the levels of chlorine and poisonous chemicals.

BIG GREEN is a patented device that uses TAC technology

The KI Big Green is a patented device (patent number EP3636598) that uses TAC technology in a highly efficient manner in order to extend the service life of the media. The tap water flows around the KALKO INNOVA Big Green Granulate. Small seed crystals of a few ten thousandths of a millimeter are formed automatically and within seconds on the surface of the granulate. These immediately detach again to make room for more crystals. The seed crystals floating in the water are carried by the water into all pipes and connected devices. They trap the limestone and thus no longer adhere to anything in the treated water. This causes the lime particles to lose their ability to adhere to surfaces and can remove existing deposits in pipes and equipment.

KI Big Green protects your entire piping system, device and equipment from aggressive lime deposits, which lead to unnecessary defects and corrosion.

Scope of delivery



KI BIGGREEN

Art.No.	90000479
Shortcode	KI-BG
Empty weight	7 kg
Packaging unit	1 pieces
Box L X B X H	23 x 23 x 48,5 cm
Customs number	84212100
EAN Number	4250188803481
Max. flow rate	37,8 l/m
Min. flow rate	11,34 l/m
Working temperature	5 - 40 ° C

max. working pressure	4,8 bar - A Pressure relief valve must be installed, if the pressure will be more than 4,8 bar
Working conditions	Only for inhouse using - Protection is required when installed outdoors.
Dimensions	254 mm (10 Zoll) x 254 mm (10 Zoll) x 457 mm (18 Zoll)
Main location	Gastronomy, industry, at home
Scope of delivery	Housing, Carbon filter, cartridge TAC, housing key, wall bracket



NH-1 KOMBI SYSTEM

Water softening and nitrate filter system

for softening and denitrification of drinking and service water up to max. 30 ° C.

Lime and nitrate in the water are currently the biggest challenges in water treatment. Solutions with filter cartridges or reverse osmosis systems are very complicated and expensive. With the new NH-1 system, you can rid your well or domestic water of nitrate and reduce the degree of hardness to a reasonable level and in a very inexpensive way. The two granules 20 liters for softening and 10 liters for denitrification are automatically regenerated regularly. Due to the large salt container, you rarely need to refill with salt.

NH-1 consisting of:

GRP pressure bottle, filled with high-quality ion exchange resin, cabinet housing for a salt supply of max. 70kg, volume-controlled central control valve type Clack WS 1 CI, integrated fine-cut valve, suction device and connection line to the central control valve.

Installation conditions:

Trink- oder Rohwasseranschluss - Steckdose 230 V / 50 Hz - Abwasseranschluss - Druckminderer bei > 6 bar - Hauswasserfilter am Eingang - Anschlussgewinde: 1".

Drinking or raw water connection - socket 230 V / 50 Hz - waste water connection - pressure reducer at > 6 bar - domestic water filter at the inlet - connection thread: 1".

Optional connection set available (ASS-2)

Also available with other capacities or as a pure nitrate removal system. For further information please request datasheets.

Optional: ASS-2

- ASS-2 Connection set 1" for NH Plant (softening and nitrate removal)
- 1x Hardness Cutlery (2-pack)
- 2x reinforced hose 1" with union nuts Length 1.000mm (DIN-) DVGW tested
- 4x seals
- 1x drain hose length 2.000mm
- 1x overflow hose length 2.000mm
- 1x hose clamp



NH-1 KOMBIANLAGE

Art.No.	90000124	max. raw water flow pressure	6,0 bar	De-nitrating granules	10 Liter
Shortcode	NH-1	min. raw water flow pressure	2,0 bar	Control head	Clack WS 1 C
Packaging unit	1 pieces	Pressure loss at max. Flow	0,6 bar	Water connections	1" AG
Box	114x32x50 cm	Salt consumption per regeneration	3,2 kg	Wastewater connection	12 mm
Weight	30 kg	Regeneration time	60 min.	Power consumption	3 Watt
For apartments to	4-6 persons	Height Cabinet housing	1.140 mm	Electrical connection	230/50/24 V
Capacity 10°dH*	8.000 L	Width cabinet housing	320 mm	Max. Water temperature	30° C
Capacity 15°dH*	5.330 L	Deep cabinet housing	500 mm	Weight of the entire system	30 kg
Capacity 20°dH*	4.000 L	Maximum salt supply	70 kg		
Nominal flow**	2,4 m3/h	GRP pressure bottle	8"x35		
Nominal flow***	0,8 m3/h	Softening granule	20 Liter		

* until the next regeneration according to DIN 19636 (20 ° dH to 8 ° dH)
 ** according to DIN 19636 (20 ° dH to 8 ° dH)
 *** from 20 ° dH to 0.5 ° dH (40 BV / h)

SYR LEX PLUS 10 CONNECT

Noticeably more beautiful and softer

LEX Plus 10 CONNECT

The LEX Plus 10 Connect soft water system has a simple, semi-automatic start-up. The system can be easily controlled via the modern touch glass display. The menu will guide you through the necessary steps in a straightforward manner. If the system is connected to the Internet via WiFi, all features can be used via the free SYR App. If soft water capacity becomes scarce, the intelligent control system of the LEX Plus 10 Connect gives priority to regeneration.

LEX Plus 10S CONNECT

The space-saving model LEX Plus 10 S Connect, with its sandwich connection fitting with blending valve, offers an easy way of connecting the DRUFI drinking water filter. If a drinking water filter from the DRUFI system is already installed, the LEX Plus 10 S Connect is the perfect solution. The result is a highly functional and compact filter and softening unit

LEX Plus 10SL CONNECT

The comfort model LEX Plus 10 SL Connect combines effective water softening with a sandwich connection fitting with leakage protection function and a flange connection for the DRUFI. Besides saving space and time during installation and commissioning, the combination offers the advantage that the integrated fittings interact and can be controlled with the SYR App: if, for example, the LEX Plus 10 SL Connect needs water for regeneration, it reports this to the leakage protection system, which releases the appropriate amount. The DRUFI drinking water filter can easily be flanged onto the connection fitting.



SYR LEX PLUS 10 CONNECT

Noticeably more beautiful and softer



The fully automatic LEX Plus 10 Connect individual softeners use the proven ion exchange process - hardness forming calcium and magnesium ions are exchanged for sodium ions - to provide soft water permanently, reliably and economically. If the systems are connected to the Internet via WiFi, all features can be used via the free SYR App.

Efficient in softening, economical in consumption: the LEX Plus 10 Connect softening water system works with modern economy salting. If the salt supply runs out, LEX reports this by SMS or e-mail.



LEX PLUS

Art.No.	LEX PLUS 10SL = 90000342 LEX PLUS 10S = 90000249 LEX PLUS 10 = 90000241
Shortcode	SLP-SL SLP-10SC SLP-10S
Empty weight	25 kg
Operating pressure	min. 2 bar, max. 8 bar
Dimensions BxHxT	352 x 615 x 570mm
Nominal pressure:	max. 10 bar
Working temperature	max. 30 °C
Salt reservoir LEX 10	25 kg
Resin quantity LEX 10	7,5 Liter
Regeneration period	50 minutes

Medium	Drinking water
Salt consumption for regeneration LEX 10	approx. 0,77 kg
Nominal flow rate nach DIN EN 14743	2,1 m³/h
Nominal flow following DIN 19636 from 20 °dH to 8 °dH	2,9 m³/h
EAN Number	LEX PLUS 10SL = 4250188802859 LEX PLUS 10S = 4250188803856 LEX PLUS 10 = 4250188803894
Packaging unit	1 piece
Shipping weight	approx. 30 kg

Attention: Without special pre-filtering, the systems are not suitable for own water (well water)

HOUSE AND WELL WATER

carbonit® QUADRO 60 / 120
FILTER MADE IN GERMANY

Water filtration for the whole house



Installation example



The best home water filtering system CARBONIT® Quadro has been extended into the HP version. The NFP and IFP Puro cartridge filters now fit within this device. Our customers can now filter their entire water system from the mains E.g. By using the IFP Puro to obtain bacteria free water. Use of the Prime Inventions EM filter cartridges with the HP Quadro is now also possible. With a water pressure of 4 bar and use of 4x NFP Premium filter cartridge 9 up to 480 l / h 4-cartridge filter system for specific, possibly larger applications and only for cold water filtration. Provides from the beginning for good water and protection of pipelines. The filters used remove in particular chlorine, organic compounds and particles. applicable when using the NFP Premium filter cartridge 9 even at high lead and copper concentrations. Advantage: by parallel filtration and quadruple housing higher flow rates are possible.

Scope of delivery:

Complete filter unit with wall bracket and manometers. The standard devices have an 1" thread. One option is to have the devices supplied with 2 pieces of flexible hose, each ca. 80 cm. long; then the connection is 3/4". Four CARBONIT® Monoblock WFP Select (L) filter cartridges are included. Please specify when ordering whether the water is to flow through the device from the left or from the right.

CARBONIT® QUADRO

Art.-No.	110Q60L1OP	110Q60R1OP	110Q120L1OP	110Q120R1OP
Shortcode	Q60L	Q60R	Q120L	Q120R
EAN Number	40248755143507	4024875143521	4024875143460	4024875143484
Box HxBxT	58 x 31 x 24 cm		98 x 31 x 24 cm	
Packaging unit	1 piece		1 piece	
Filter cartridges (Filter cartridges must always be ordered separately as many variants are possible)	4 x Carbonit® WFP...		4 x Carbonit® WFP L...	
MORE INFORMATIONS AT PAGE 92				
Performance	depends on the choosed filter cartridge type			
Dimensions	31 x 58 x 24 cm		31 x 98 x 24 cm	
Weight	dry approx. 16 kg wet approx. 24 kg		dry approx. 25 kg wet approx. 40 kg	
Attention!	A free space above and below the filter is necessary for changing the filter: approx. each side 28 cm		approx. each side 50 cm	

FILTER CARTRIDGES



At Prime Inventions you will find the right filter cartridges for every purpose!

The following filter cartridges in 9 3/4" size are suitable for Prime Inventions and Carbonit® countertop and under-sink filter housings and are divided into three groups:

Active carbon filters filter cartridges

effective reduction of:

- Chemicals (e.g. chlorine, lead, fluoride)
- Herbicides, pesticides, drug residues
- Microplastics Bacteria (z.B. Escherichia coli, Enterococcus faecalis)
- Viruses (in active carbon combi-filters with UF membrane)

Ion-exchanging filter cartridges

To filter or convert specific substances in the water by adsorption to decalcify the water e.g. for hot drinks to remove arsenic, nitrate or fluoride

Special filter cartridges

- for mineralization after reverse osmosis (AA Calci)
- for sediment pre-filtering and reduction of biofilm/bacteria
- for specific filtration of heavy metals (KDF filter)

Model	Shortcode	Filter fineness	Water Flow rate	Type	Features
EM Premium 5	FC-EM 1	0,45 µm	ca. 2 l/m	Carbon with EM	Water enlivenment with EM Ceramics
EM Premium D	FC-EM 7	0,7 µm	ca. 3 l/m	Carbon with EM	Water enlivenment with EM Ceramics
EM Puro	FC-EM 8	0,15 µm (Membrane) 5 µm (Carbon)	ca. 6-8 l/m	Carbon with EM	For low water pressure Water enlivenment with EM Ceramics
EM Aquawhirler	FC-EMA	0,7 µm	ca. 3 l/m	Carbon with 5% EM	With intergrated whirling chamber - Water enlivenment with 5% EM Ceramics
NFP Premium	NFP-9	0,45 µm	ca. 2 l/m	Carbon with EM	Hygienical characteristics
IFP Puro	IFP-Puro	0,15 µm (Membrane) 5 µm (Carbon)	ca. 6-8 l/m	Carbon with mit capillary membrane	high flowrate for special applications (Medical technic, Water dispenser)
IFP4,5-9KDF	IFP-KDF	0,15 µm	1,5 l/m	Carbon with KDF55	recommended for high heavy metal loads
AA Calci	MC-1	-	up to 4 l/m	Calciumgranule	Calcium granule for mineralization
AA Calci EM	MC-2	-	up to 4 l/m	Calciumgranule	Calcium granule for mineralization with EM Ceramics
Entkalkung EK 7S	EK-7	Teilenthärtung	2 l/m	Ion exchanger	Anti-lime scale - not regenerable
Entkalkung EK 6H	EK-6H	Vollenthärtung	2 l/m	Ion exchanger	Anti-lime scale - regenerable
SC-99 Sedimentfilter	SC-99	1 µm	20l/min	Sediment filter	Pre-filter with bacterial protection

FILTER CARTRIDGES FOR AA UNO / TWIN

Membranefilter	MF-1	0,05 µm	ca. 8 l/min	Membrane filter	Bacteria and pollutant reduction
Sedimentfilter	SF-66	1 µm	ca. 8 l/min	Sediment filter	Pre-filter
EM Premium	FC-EUN	0,45 µm	ca. 2 l/min	Carbon with EM	Water enlivenment with EM Ceramics

GRANULES

Granules

Overview of all available granulate filter media with their areas of application



carbonit® **EM PREMIUM 5** FILTER MADE IN GERMANY

Water filtration and enlivenment

The new CARBONIT® Premium EM Premium 5 filter cartridge is combining water filtration and enlivenment in one cartridge

A "special clay" is used for the manufacture of the EM-ceramics, which contains the organic material of plants, which are millions of years old and are food for the EM™ Effective Microorganisms during the several month long fermentation process. Among other things EM ceramics reduces the surface tension of the water, and decreases the size of the cluster structures. In this way the natural condition of the water will be restored.

The EM ceramics is "baked" into the filter cartridge during production. In this way there is a very large contact surface with the water. Together with the tried and tested filter ability, of CARBONIT® NFP Premium filter technology provides the ideal water filtration. Pollutant retention EM Premium 5 see: NFP Premium The pollutant retention EM premium D is about 90% from the EM Premium 5.

EM PREMIUM 5

Art.No.	88898800
Shortcode	FC-EM1
Weight	450g net
Height	248mm
Diameter	73mm
Material Filterblock	Carbon
Flow rate	approx. 2 l/min (pressure dependent)
Performance	approx. 10.000 Liter
Filter fineness	0,45 µm
Packaging unit	24 pieces
Box	285 x 80 x 80 mm
Box PU 24 pieces	600 x 300 x 400 mm
Weight PU 24 pieces	approx. 16kg incl. Box

Customs number	84219900
EAN number	4250188800930
Changing interval	6 Months
Manufactured in	Germany
Pollutant retention	See certificate NFP
Bacteria retention	Yes
Manufacturer	Carbonit® exclusive f. Prime Inv.
Pallet	24 Boxes x 24 = 576 pieces
Manufactured for	9 3/4" Filter housing
Main location	Kitchen
Restrictions for use	Use only cold water Not behind unpressurized boilers!

FILTER CARTRIDGES

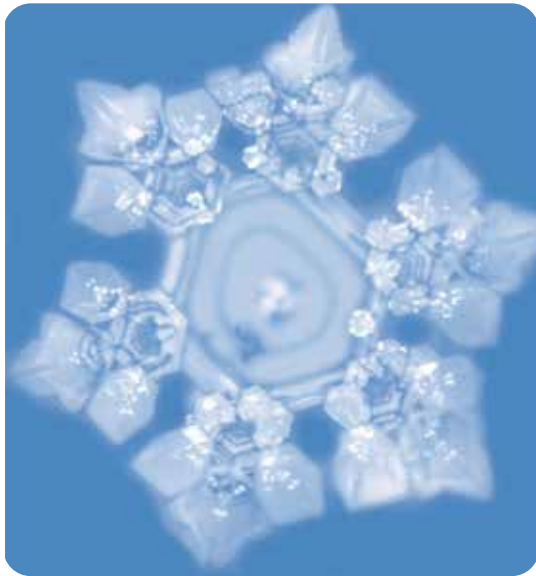

Filtered drinking water with Premium EM Premium filter cartridge



To compare: Trinkwasser aus Thun
 Orderd by: Prime Inventions GmbH
 Examined by:
 Ernst F. Braun - CH-3664 Burgstein
 Mai 2007 © - Probe Nr: 803

carbonit® **EM PREMIUM D** FILTER MADE IN GERMANY

With higher flow rate

Pollutant retention EM Premium 5 + D see NFP Premium

The pollutant retention of the EM Premium D is approx. 90% of the filter performance of the EM Premium 5.

Service life PREMIUM 5 + D:

The filter cartridge must be replaced after 6 months (in accordance with DIN 1988). As a basic rule, 10,000 litres of water can be filtered within a six-month period. Earlier replacement can however be necessary when the water flow becomes noticeably reduced. Earlier replacement is not the result of any deficiency in the filter used, but rather a sign of the increased presence of fine particles

Left pictures : photographed Water crystal of drinking water

filtered with EM Premium, photographed on top of frozen water drops. Water drops of drinking water, filtered with EM Premium, have been frozen and photographed digitally under the microscope.

To compare with distilled water: there are very seldom crystalline shapes, messages, stars, etc. visible when we freeze distilled water drops.

EM PREMIUM D

Art.Nr.	88808268	Weight PU 24 pieces	approx. 16kg incl. box
Shortcode	FC-EM7	Customs number	8421 9900
Weight	450g net	EAN number	4250188808370
Height	248mm	Cahniging interval	6 Months
Diameter	73mm	Manufactured in	Germany
Material Filterblock	Carbon	Pollutant retention	See certificate NFP
Flow rate	approx. 3 l/min (pressure depend)	Bacteria retention	Yes
Performance	approx. 10.000 Liter	Manufacturer	Carbonit® exclusiv f. Prime Inv.
Filter fineness	0,7 µm	Pallet	24 Boxes x 24 = 576 pieces
Packaging unit	24 pieces	Manufactured for	9 3/4" Filter housing
Box	285x80x80mm	Main location	Kitchen
Box PU 24 pieces	600x300x400mm	Restrictions for use	Use only cold water

FILTER CARTRIDGES

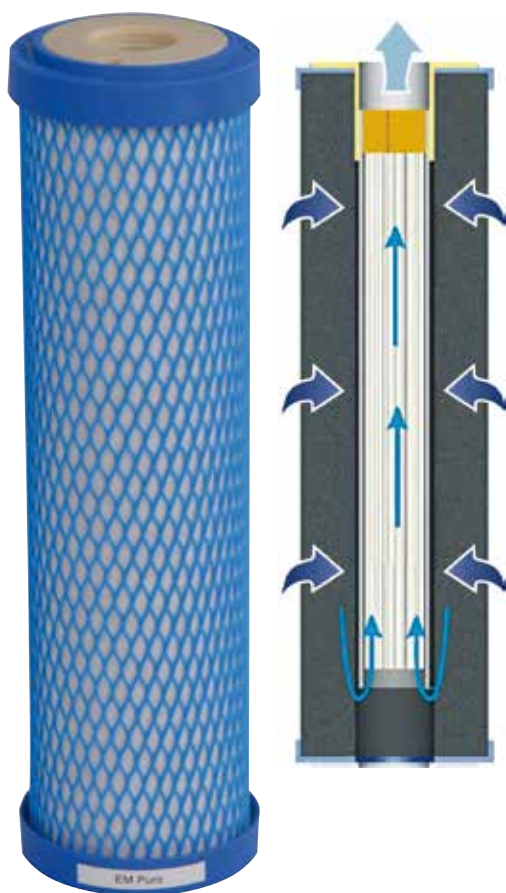

carbonit® **EM PURO**
FILTER MADE IN GERMANY

FILTER CARTRIDGE FOR HIGH WATER FLOW

Awarded with the innovation prize of Sachsen-Anhalt (Germany) in 2002. Due to its high water flow, the IFP Puro is especially well suitable for use with water-whirlers to enliven drinking water. Activated carbon has a large surface that is often used as an adsorbent in the chemical-, pharmaceutical industry as in waste water treatment. Mainly it removes unwanted tastes and odors from gases and fluids. Produced as a sintered active carbon block in the patented Carbonit®-technology, it has scientifically proven, unique filter properties.

Hospital hygienists have documented that tap water can be a transfer medium for Legionella, Pseudomonads and fungal diseases. Scientific studies from the hygienic institute at the university of Bonn have shown that that this not only can occur in hospitals, nut also at home. In this case immunodeficient people are especially endangered. These filters can ensure protection. The capillary membrane is made of Polyethersulfone.

Service life:

The cartridge filter can be replaced after 6 months (according to DIN 1988). Basically, 10,000 liters of water must be filtered within 6 months. However, earlier change may be necessary if the water flow is noticeably reduced. Earlier replacement is not a defect of the filter used, but an indication of increased presence of fine particles in unfiltered water.

NEW IN 2021: EM PURO WITH VIRUS FILTERING!

EM PURO

Art.Nr.	88808899	Weight PU 24 pieces	approx. 16kg each box
Shortcode	FC-EM8	EAN number	4250188808899
Weight	450 g net	Changing interval	6 Months
Height	248 mm	Manufactured in	Germany
Diameter	73 mm	Pollutant reduction	yes
Material Filterblock	Carbon	Bacteria reduction	yes
Flow rate	approx. 6-8 l/min (pressure depend)	Manufacturer	Carbonit® or Prime Inventions
Performance	approx. 5.000 L	Pallet	24 boxes x 24 (576 pieces)
Filter fineness	0,15 µm	Manufactured for	9 3/4" Filter housing
Packaging unit	24 Pieces	Main location	Kitchen
Box	285 x 80 x 80 mm	Restrictions for use	Use only cold water - Not behind unpressurized boilers!
Box PU 24 pieces	600 x 400 x 300 mm		

FILTER CARTRIDGES



EM AQUAWHIRLER

Filtration with integrated water whirling!

Building on the proven EM D premium, the EM Aquawhirler which has an integrated water whirler unit that consists of a high-quality PETG-material and is also bacteria-repellent thanks to the special coating, thus positively reducing bacteria contamination within the cartridge filter. The EM Aquawhirler filter cartridge is exclusively manufactured by CARBONIT® for Prime Inventions GmbH. It has a mechanical filter fineness of <0.7 microns and a very high chemical and physical adsorption to chemical agents. With the addition of about 5% EM-Ceramic EM = Effective Microorganisms) it receives a specific feature. The cartridge filter is ideal for those customers who cannot connect a water whirler at the faucet. By exchanging the filter you will always have a clean new water whirler which is integrated within the existing carbon block. Carbon Block: Fineness 0.7 my with 5% EM Filter performance About 90% of CARBONIT® NFP Premium Water flow: Approx. 3/ min. Depending on the water pressure Temperature: For technical reasons, use only with cold water, protect from frost.

Service life:

The cartridge filter must be replaced after 6 months (according to DIN 1988). Basically, 10,000 litres of water must be filtered within 6 months. However, earlier change may be necessary if the water flow is noticeably reduced. Earlier replacement is not a defect of the filter used, but an indication of increased presence of fine particles in unfiltered water.

This EM-Aquawhirler filter cartridge fits into the CARBONIT® filter units SA-NUNO, Vario-HP and Duo-HP as well as in the Prime Inventions filter devices

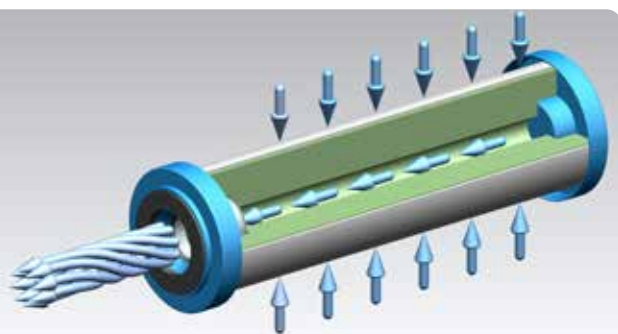

EM AQUAWHIRLER

Art.No.	88819888	Customs number	84219900
Shortcode	FC-EMA	EAN number	4250188819888
Weight	450g net	Changing interval	6 Months
Height	248mm	Manufactured in	Germany
Diameter	73mm	Pollutant reduction	See certificate
Material Filterblock	Carbon	Bacteria reduction	yes
Flow rate	approx. 3 l/min (pressure depend)	Manufacturer	Carbonit® exclusive f. Prime Inv.
Performance	approx. 10.000 Liter	Pallet	24 Boxes x 24 = 576 pieces
Filter fineness	0,7 µm	Manufactured for	9 3/4" Filter housing
Packaging unit	24 pieces	Main location	Kitchen
Box	285x80x80mm	Min. working pressure	approx. 1 bar, ideal 3-4 bar
Box PU 24 pieces	600x300x400mm	Restrictions for use	Use only cold water - Not behind unpressurized boilers!
Weight PU 24 pieces	approx. 16kg incl. box		

FILTER CARTRIDGES



carbonit® NFP PREMIUM FILTER MADE IN GERMANY

The classic filter cartridge

We recommend the use of the NFP Premium Drinking Water Cartridge for removing buildups of such substances in domestic pipe lines as lead and copper. This filter cartridge is utilised in all CARBONIT® Drinking Water Filters, due to its high performance capability in the face of possible drinking water contaminants and the excellence of its hygienic characteristics.

Service life:

The filter cartridge must be replaced after 6 months (in accordance with DIN 1988). As a basic rule, 10,000 liters of water can be filtered within a six-month period. Earlier replacement can however be necessary when the water flow becomes noticeably reduced. Earlier replacement is not the result of any deficiency in the filter used, but rather a sign of the increased presence of fine particles in unfiltered water. Filter fineness: approx. 0.45 µm

Contaminant retention NFP Premium

Parameter	Reduction	Certifying Authorities
Escherichia coli ¹	>99,9%	GFT / Uni
Enterococcus faecalis ¹	>99,9%	Bielefeld
Lead ²	>90%	TÜV Umwelt
Copper ²	>90 %	TÜV Umwelt
Chlorine ²	>99%	
Chloroform ²	>99,9%	tti Magdeburg
Lindane ²	>99,8%	GmbH/
DDT ²	>99,8%	FH Magdeburg
Atrazin ²	>99,8%	

¹ Test with load during 6-month period of use

² Test with load for filter capacity of 10,000 liters

Parameter	Reduction	Certifying Authorities
Medical residues.²		
- Clofibrin acid	>99,9%	
- Carbamazepine	>99,9%	
- Diclofenac	>99,5%	
- Ibuprofen	>99,9%	
- Ketoprofen	>99,9%	
- Propiphenazon	>99,9%	TUBerlin
Polar Pestizides²		
- Bentazon	>99,9%	
- 2,4 D	>99,9%	
- Dichlorprop.	>99,9%	
- MCPA	>99,9%	
- Mecoprop.	>99,9%	
- p.p'-DDA	>99,5%	

NFP PREMIUM

Art.Nr.	205NFP020-EV
Shortcode	NFP
Weight	450g net
Height	248mm
Diameter	73mm
Material Filterblock	Carbon
Flow rate	approx. 2l/min (pressure depend)
Performance	approx. 10.000 Liter
Filter fineness	0,45 µm
Packaging unit	24 pieces
Box	285x80x80mm
Box PU 24 pieces	600x300x400mm
Weight PU 24 pieces	approx.. 16kg incl. box

Customs number	84219900
EAN number	4024875143781
Changing intervall	6 Months
Manufactured in	Germany
Pollutant reduction	See certificate
Bacteria reduction	yes
Manufacturer	Carbonit®
Pallet	24 Boxes x 24 = 576 pieces
Manufactured for	9 3/4" Filter housing
Main location	Kitchen
Min. pressure	approx. 1 bar, ideal 3-4 bar
Restrictions for use	Use only cold water - Not behind unpressurized boilers!

FILTER CARTRIDGES



carbonit® IFP KDF
FILTER MADE IN GERMANY

Filter cartridge for high heavy metal reduction

For water filtration in the kitchen and bathroom shortly before the removal (point of use). Priority use with high heavy metal contamination (such as iron, lead, nickel, copper, mercury). | Combined activated carbon KDF granulate filter cartridge | Activated carbon filter part (sintered) with 1.5 micron fineness | Filter granules inside order with KDF 55 add. Distance / reduction of dissolved metal compounds (heavy metals) KDF has antibacterial and against fungi and algae - reduces chlorine, pesticides and hydrogen sulfide.

The filter cartridge must be replaced after 6 months (according to DIN 1988). In principle, up to 10,000 liters of water may be filtered during this period. However Earlier replacement may be necessary when the water flow becomes noticeably reduced. Earlier replacement is not a deficiency in the filter used, but rather a sign of the increased presence of fine particles in unfiltered water.

Contamination reduction

KDF 55

Lead, copper, iron, nickel, chrome, cadmium, aluminium, mercury,, Arsen, Zinc

up to 99 %*

Carbon filter part

Chlorine, chloroform, lindan, DDT, atrazin, Medical residues., polare pestizides

> 70 %**

*) certified from the American National Science Foundation – NSF

***) compared to the cartridge NFP Premium

IFP KDF

Art.No.	220 FP045-9KDF
Shortcode	IFP-KDF
Weight	450 g net
Height	248 mm
Diameter	73 mm
Material Filterblock	Carbon, KDF
Flow rate	approx. 1,5 l/min (pressure depend)
Performance	10.000 L
Filter fineness	1,5 µm
Packaging unit	24 pieces
Box LxHxB	285 x 80 x 80 mm
Box PU 24 pieces	600 x 300 x 400 mm
Weight	approx 16 kg incl. box

Customs number	8241 9900
EAN Number	4250188803382
Chahnging interval	6 Monzhs
Manufactured in	Germany
Pollutant retention	Heavy metal
Manufacturer	Carbonit®
Pallet	24 x 24 = 576 Stück
Manufactured for	9 3/4" Filter housing
Main location	Kitchen
Restrictions for use	Use only cold water - Not behind unpressurized boilers!

FILTER CARTRIDGES

carbonit® IFP PURO
FILTER MADE IN GERMANY

Filter cartridge with high flow rate

9 3/4 combined cartridge of activated carbon and axially integrated capillary membrane. Awarded the Innovation Prize of Saxony-Anhalt in 2002. The high water flow is particularly suitable for the use of turbulators for the revitalization of drinking water. activated carbon has a large surface that under the adsorbent used in the chemical, medicine and water and wastewater treatment is used. As gesinteter activated carbon block filter in accordance with scientifically verified CARBONIT® technology removes unwanted primarily the color, taste and odor compounds from gases, vapors and liquids unparalleled filtration results scientifically verified. membrane filtration for reliable retention of pathogenic germs. We filter in the field of micro-filtration . Please note laid down by the legislature semiannual filter change (backwash filter must be flushed every 2 months). ordering advice and our products are sold exclusively through authorized dealers. Filter performance combination of two technologies for high water flow in special applications (medical, water dispensers) and convenient operation with downstream technical equipment or turbulators. Hospital Hygienist document as Legionella, Pseudomonas, and fungi (eg Aspergillus) the tap water can be a source of transmission. Scientific studies of the Institute of Hygiene and Public Health, University of Bonn show that these stresses can occur not only in hospitals but also in the home environment . Here immune-compromised individuals terminal Filters are primarily at risk. offer protection. Compared to the „plain carbon block NFP Premium“ is a halving of the activated carbon capacity and a doubling of the sales price before. Filtration capacity of about 5,000 liters. Scientifically checked filter composition. For the filtration of bacteria and organic substances. Meets ANSI / NSF Standard 53 (cyst & turbidity reduction) and EPA standards. The epdwa guidelines for a filter fineness of at least 1 micron (1 micron) in nominal terms and a recommended filter change every 6 months are observed. Everything for your safety!

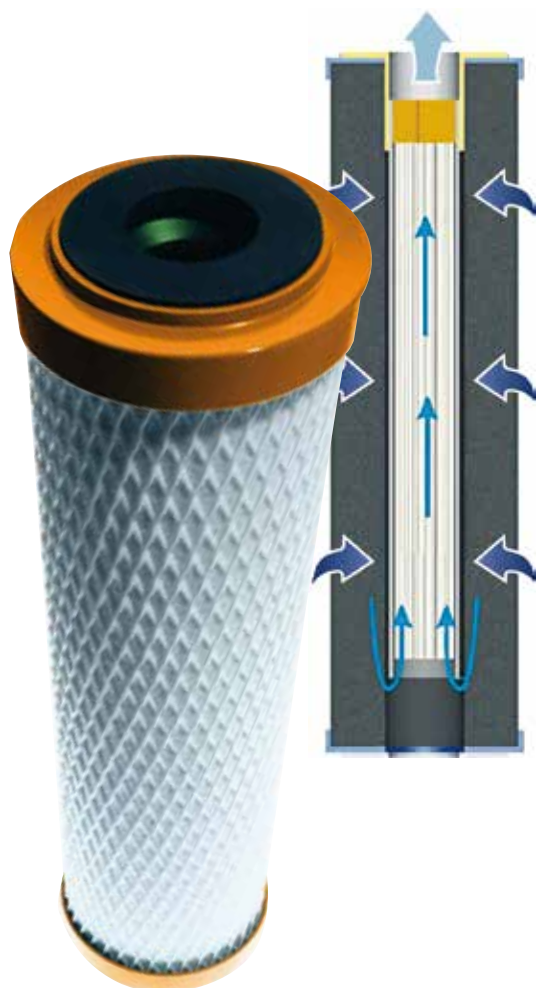

IFP PURO

Art.No.	220IFPPuro-EV	Box PU 24 pieces	600x300x400mm
Shortcode	IFP-Puro	Weight Pu 24 pieces	approx. 16kg incl. box
Weight	450g net	Customs number	8241 9900
Height	248mm	EAN number	4024875143828
Diameter	73mm	Changing interval	6 Months
Material Filterblock	Carbon + capillary membrane	Pollutant reduction	See certificate
Flow rate	approx. 4-8l/min (pressure depend)	Bacteria reduction	yes
Performance	approx. 10.000 Liter	Pallet	24 Boxes x 24 = 576 pieces
Filter fineness	Carbon 5 µm	Manufactured for	9 3/4" Filter housing
	Capillary membrane 0,15 µm	Main location	Kitchen
Packaging unit	24 pieces	Mind. working pressure	approx. 1 bar, ideal 3-4 bar
Box	285x80x80mm	Restrictions for use	Use only cold water - Not behind unpressurized boilers!

AA CALCI

Mineralisation cartridge



AA Calci is simply inserted between the AA Osmo (or other reverse osmosis device) and the tap. AA Calci is an optional mineralisation step which gives the filtered water a small amount of minerals. The installation can be installed in reverse osmosis installations either between the tank and the tap or directly after the reverse osmosis membrane. As the water flows very slowly over the coral calcium directly after the reverse osmosis membrane, this installation produces a greater level of mineralisation than installing the device between the tank and the tap. The Okinawa calcium granulate is obtained from the Okinawa coast under controlled and absolutely environmentally friendly conditions. This fossilized coral is also used to add additional nutrients to food in powder form, for example in muesli. It is also made into calcium tablets. For Prime Inventions, coarser granules are made which have the optimal size and consistency for the mineralisation of drinking water. The Calci EM also contains EM pipes. For more information on EM, see the section on EM 5 filter cartridges. For more information on EM, see on page EM ceramics.

Operating life:

Up to one year, depending on usage

Attention:

The calcium granulate has been sterilized by heating. Please install under hygienic conditions.

Scope of delivery:

- MC-1 Calci Mineralisation cartridge
- MC-2 EM Calci Mineralisation cartridge

AA CALCI

Art.No.	MC-1= 88800213 MC-2 = 88800215	Box PU 24 pieces	600 x 300 x 400
Shortcode	MC-1 MC-2	Weight PU 24 pieces	approx. 20 kg
Weight	584 gr	Customs number	8421 9900
Height	248 mm	EAN number	MC-1= 4250188800213 MC-2 = 4250188800220
Diameter	73 mm	Changing interval	up to one year
Material	calcium granukate	Pallet	24 boxes x 24 = 576 Stück
Flow rate	approx. 2l/min	Manufactured for	9 3/4" Filter housing
performance	approx. 10.000l	Main location	Kitchen
Packaging unit	24 pieces	Min. working pressure	1 bar
Box	285 x 80 x 80 mm	Restrictions for use	Use only cold water - Not behind unpressurized boilers!

ANTI LIME SCALE CARTRIDGES



EK-7S - not regenerable

AA Calci is an optional mineralisation step which gives the filtered water a small amount of minerals. The installation can be installed in reverse osmosis installations either between the tank and the tap or directly after the reverse osmosis membrane. As the water flows very slowly over the coral calcium directly after the reverse osmosis membrane, this installation produces a greater level of mineralisation than installing the device between the tank and the tap.

EK-6GH - regenerable

Decalcification cartridge EK-6H for cold and hot drinks The EK-6H decalcifying cartridge improves the taste of cold and hot drinks (especially to improve the aroma of coffee and tea) and protects household appliances from calcification. The flowed through ion exchange resin reduces the total hardness of the water and can be repeatedly regenerated with a brine. This saves costs and protects the resources. A regeneration manual with information about exactly what you need is available on request from your dealer. The water low should not exceed about 2 l / min. so that a noticeable decalcification is guaranteed. The possible service life depends on hardness of the input ater. Depending on the raw water hardness are up to 1,900 l (hardness 5-10 dh)

ANTI LIME SCALES CARTRIDGES EK 6GH + EK 7S

Art.Nr.	EK-7S: 88802453 EK-6GH: 9000034
Shortcode	EK-7S EK-6GH
Weight	400 g
Height	248 mm
Diameter	73 mm
Material	EK-7S = Ion exchanger resin EK-6GH = Granulate total hardness
Flow rate	approx. 2 l/min
Performance	up to 1.900 l (degree of hardness 5-10dH) up to 450 l (degree of hardness 11-25 dH)

Packaging unit	24 pieces
Box	285 x 80 x 80 mm
Box PU 24 pieces	600 x 400 x 300 mm
Pallet	24 Boxes x 4 = 576 piecesk
Weight PU 24 pieces	approx. 18kg
EAN number	EK-7S: 4250188802453 EK-6GH: 4250188806581
Customs number	84219900
Changing interval	max. 6 Months
Manufactured for	9 3/4" Filter housing
Main location	Kitchen
Min. working pressure	1 bar



SEDIMENT FILTER SC-99

Reduction from bacteria and sediments

SC-99 is a special textile pre-filter, eg to remove strong particle-laden or polluted (turbidity) input water. It is made with an anti-bacterial protection. Due to the special winding, the protection is distributed over a very large area. Upon contact of bacteria with the protective surface the majority of bacteria cannot reproduce. Water having a high content of sediments affect the optical in beverages and at worst can have a damaging effect on your system components.

Service life:

The filter cartridge must be replaced after 6 months (in accordance with DIN 1988). As a basic rule, 10,000 litres of water can be filtered within a six-month period. Earlier replacement can however be necessary when the water flow becomes noticeably reduced. Earlier replacement is not the result of any deficiency in the filter used, but rather a sign of the increased presence of fine particles in unfiltered water. The water flow of a new cartridge is up to 20 liters / min depending on water pressure and filter housing. Protect from frost.

SC-99

Art.No.	88818799
Shortcode	SC-99
Weight	450g net
Height	248 mm
Diameter	73 mm
Flow rate	approx. 20 l/min (pressure depend)
Performance	approx. 10.000l
Packaging unit	12 pieces
Box	285 x 80 x 80mm
Box PU 12 pieces	400 x 300 x 150 mm
Weight PU 12 pieces	approx. 6kg incl. Box

Customs number	84219900
EAN number	4250188818799
Changing interval	6 Months
Manufactured in	Germany
Filter fineness	> 1 µm
Bacteria retention	yes
Manufactured for	9 3/4" Filter housing
Main location	Kitchen
Min. working pressure	approx. 1 bar, ideal 3-4 bar
Restriction for use	Use only cold water - Not behind unpressurized boilers!



MEMBRANE FILTER FOR AA UNO/TWIN

Reduction of pollutants and bacteria

The MF-1 membrane filter cartridge serves to filter and retain pollutants and bacteria and has a filter fineness of 0.05 µm. The membrane surface is washable under running water. Can therefore also be used as a pre-filter, e.g. before EM Premium UNO.

The new secure thread connection has been specially made for the stainless steel countertop filter series Aqua Avanti VA UNO and Twin. The new membrane filter is used as the sole filter or to extend an existing filter system for the retention of viruses and bacteria. Even if the filter stages used in the standard filter system are already bacteria-proof, the MF1 extends this to include additional retention of viruses in the water

MF1

Art.No.	90000385	EAN number	4250188803283
Shortcode	MF-1	Changing interval	6 Month
Weight	60 g net	Pollution retention	Sediment + pollutants bigger as 0,05 µm
Height	250 mm incl. thread	Virus retention	yes
Diameter	47 mm	Bacteria retention	yes
Flow rate	approx. 8 l/min (pressure depend) Max. ca. 8.000 Liter	Filter fineness	0,05 µm
Packaging unit	24 pieces	Pallet	24 Boxes x 24 = 576 pieces
Box	260 x 70 x 70 mm	Manufactured for	9 3/4" Filter housing
Box PU 24 pieces	600 x 400 x 300 mm	Main location	Kitchen
Weight PU 24 pieces	approx. 1,8 kg incl. Box	Min. working pressure	1 bar
Customs number	8421 9900	Restrictions for use	Use only cold water - Not behind unpressurized boilers!



SEDIMENT FILTER FOR AA UNO/TWIN

Reduction of the biofilm

The SF-66 sediment filter cartridge is used for pre-filtering and has a mechanical filter unit of 1 µm. The new secure thread connection has been specially made for the stainless steel countertop filter series Aqua Avanti VA UNO and Twin. Textile coarse and preliminary filter, e.g. for the removal of heavily particle-loaded or dirty (turbidity) input water. Water with a high sediment content impairs the visual value of beverages and, in the worst case, can have a damaging effect on your components.

The filter cartridge must be replaced after six months. In principle, up to 10,000 liters of water may be filtered during this period. However, an earlier replacement may be necessary if the water flow is noticeably reduced. The water flow rate is now up to 8 liters/min, depending on water pressure and filter housing. Protect from frost.

SF-66

Art.No.	90000384	Customs number	8421 9900
Shortcode	SF-66	EAN number	4250188803306
Weight	66 g net	Changing interval	6 Months
Height	250mm incl. thread	Pollutant reduction	Sediment + pollutants bigger as 1 µm
Diameter	47 mm	Filter fineness	1 µm
Flow rate / performance	approx. 8 l/min (pressure depend) Max. ca. 8.000 Liter	Pallet	24 Boxes x 24 = 576 pieces
Packaging unit	24 pieces	Manufactured for	9 3/4" Filter housing
Box	260x70x70mm	Main location	Kitchen
Box PU 24 pieces.	600 x 400x 300 mm	Min. working pressure	1 bar
Weight PU 24 pieces	approx. 2 kg	Restrictions for use	Use only cold water - Not behind unpressurized boilers!



EM PREMIUM UNO FOR AA UNO/TWIN

Active carbon filter

EM Premium UNO combines filtering and revitalizing water and is produced exclusively by Carbonit® for Prime Inventions. The new secure thread connection ensures a secure sealing of the filter cartridge in the filter housing. For the production of the EM ceramics a special fired clay is used, which contains organic material from plants that are millions of years old and are food for the EM Effective Microorganisms (EM Effektive Mikroorganismen®) during the fermentation process of several months. Among other things, EM ceramics reduce the surface tension of the water and the size of the cluster structures. This restores the natural condition of the water.

The EM ceramic is “baked” into the filter cartridge as a powder during production. This creates a very large contact surface with the water. Together with the proven filter performance of the Carbonit® NFP Premium filter technology, this results in the ideal water filtration. Activated carbon has a large surface area and is used as an adsorbent in the chemical, medical, water and wastewater treatment industries, among others. It primarily removes unwanted pollutants, colorants, flavorings and odors from gases, vapors and liquids.

FC-EUN

Art. No.	90000355	Customs number	84219900
Shortcode	FC-EUN	EAN Number	4250188803290
Weight	245 g without packaging	Changing interval	6 months
Height	248 mm	Manufactured in	Germany
Diameter	50 mm	Pollutant retention	See certificate NFP
Flow rate	3-4 l/m	Bacteria retention	yes
Packaging unit	24 Stück	Pallet	24 Boxes x 24 = 576 pieces
Box LxBxH	60 x 40 x 30 mm	Manufactured for	9 3/4" Filter housing
Box PU 24 pieces	285 x 80 x 50 mm	Filter fineness	0,45 µm
Weight PU 24 pieces	approx. 14 kg incl. box	Main location	Kitchen
		Restrictions for use	Use only cold water - Not behind unpressurized boilers!

FILTER GRANULATE 850 ML

REFILL AA PROFI



KI-800

KALKO INNOVA Refill



Art.No.	90000371
Shortcode	KI-800
EAN	4250188803573
Content	850 ml
Packaging unit	1 piece
Box LxBxH	240x160x45 mm

EK-6S-800

Softening granules for total hardness
regenerable



Art.No.	90000381
Shortcode	NFPPEK6S
EAN	4250188803597
Content	850 ml
Packaging unit	1 piece
Box LxBxH	240x160x45 mm

AGN-800

Arsenic removal granulate



Art.No.	90000379
Shortcode	AGN-800
EAN	4250188803610
Content	850 ml
Packaging unit	1 piece
Box LxBxH	240x160x45 mm

MC-2-800

Calci+EM pipes
Mineralization granulate with EM Pipes



Art.No.	90000383
Shortcode	MC-2800
EAN	4250188803559
Content	850 ml
Packaging unit	1 piece
Box LxBxH	240x160x45 mm

MC-CALCI-800

MC-Calci-800
Mineralization granulate



Art.No.	90000382
Shortcode	MC-800
EAN	4250188803535
Content	850 ml
Packaging unit	1 piece
Box LxBxH	240x160x45 mm

EK-7-800

Softening granules for
Carbon hardness



Art.No.	90000388
Shortcode	EK-7NP-800
EAN	4250188803511
Content	850 ml
Packaging unit	1 piece
Box LxBxH	240x160x45 mm

NK-7-800

Nitrate removal granulate



Art.No.	90000390
Shortcode	NK7-800
EAN	4250188803498
Content	850 ml
Packaging unit	1 piece
Box LxBxH	240x160x45 mm

FILTER GRANULATE 450ML

REFILL FOR

EMPTY CARTRIDGE EC-9 WHITE 10"

Art.No.	90000150
Shortcode	EC-8
EAN	4250188804044
Height	250mm
Diameter	70mm
Empty weight	108 g
Packaging unit	4 pieces
Box	35 x 25 x 13 cm



KI-400

KALKO INNOVA Refill



Art.No.	90000351
Shortcode	KI-450
EAN	4250188803580
Content	450 ml
Packaging unit	4
Box LxBxH	240x160x45 mm

EK-6S GH

Softening granules for total hardness regenerable



Art.No.	90000370
Shortcode	EK6SNP
EAN	4250188803603
Content	450 ml
Packaging unit	4
Box LxBxH	240x160x45 mm

AGN

Arsenic removal granulate



Art.No.	90000373
Shortcode	AGN1
EAN	4250188803627
Content	450 ml
Packaging unit	4
Box LxBxH	240x160x45 mm

MC-2

Calci+EM pipes
Mineralization granulate with EM Pipess



Art.No.	90000256
Shortcode	MC-2
EAN	4250188803566
Content	450 ml
Packaging unit	4
Box LxBxH	240x160x45 mm

MC-CALCI

Calci Mineralization granulate



Art.No.	90000360
Shortcode	MCCNP
EAN	4250188803542
Content	450 ml
Packaging unit	4
Box LxBxH	240x160x45 mm

EK-7 KH

Softening granules for
Carbon hardness



Art.No.	88805430
Shortcode	EK7NP
EAN	4250188803528
Content	450 ml
Packaging unit	4
Box LxBxH	240x160x45 mm

NK-7

Nitrate removal granulate



Art.No.	90000372
Shortcode	NK7NP
EAN	4250188803504
Content	450 ml
Packaging unit	4
Box LxBxH	240x160x45 mm



AQUA AVANTI INLINE FILTER CARTRIDGES

In this category you will find suitable filter cartridges for your Aqua Avanti Inline system

Extremely simple filter change

Filter change: Close the water supply valve, unscrew the old filter cartridge clockwise and pull it down. Insert the new filter cartridge from below and screw it in counterclockwise until it stops. Re-open the water supply.

When should it be replaced?

The filter cartridges have to be replaced regularly. Precise information about the replacement intervals can be found in the relevant item table. However, an earlier replacement may be necessary if the water flow is noticeably reduced. This is generally an indication of the increased occurrence of fine particles in the unfiltered water.

Only use cold water, protect from frost.

Inline-Model	Shortcode	Filter fineness	Flow rate	Type	Features
EM Premium 5	FP-1	0,45 µm	approx. 2 l/m	Carbon with EM	Water enlivenment with EM ceramics
EM IFP Premium 5	FP-2	0,45 µm	approx. 3 l/m	Carbon with EM	ideal at low water pressure - Water enlivenment with EM ceramics
SC-99	FP-3	1 µm	approx. 10 l/m	Sediment filter	Prefilter with bacteria protection
EM Calci	FP-4		approx. 4 l/m	Calcium granulate	for mineralization after reverse osmosis
Entkalkung EK-7	FP-5		approx. 2 l/m	Ion exchanger	for water softening
FP-7 viruses filtering	FP-7		approx. 4 l/m	Disruptor®	viruses and bacteria filtering

INLINE-CARTRIDGES

EM PREMIUM 5 INLINE



Water filtration and enlivenment

A "special clay" is used for the manufacture of the EM-ceramics, which contains the organic material of plants, which are millions of years old and are food for the EM™ Effective Microorganisms during the several month long fermentation process. Among other things EM ceramics reduces the surface tension of the water, and decreases the size of the cluster structures. In this way the natural condition of the water will be restored. The EM ceramics is "baked" into the filter cartridge during manufacture. In this way there is a very large contact surface with the water.

EM PREMIUM 5 INLINE

Art.No.	88802200
Shortcode	FP-1
Weight	780 g
Height	32 cm
Diameter	10 cm
Flow rate	depending on pressure up to 2 l/min
Filter fineness	0,45 micron
Performance	approx. 10.000l
Box 24 pieces.	60 x 40 x 35 cm
Weight 24 pieces	ca. 20 kg
EAN Number	4250188802200
Changing interval	6 months up to 10.000 l
Manufactured in	Germany
Pollutant reduction	See certificate NFP Premium
Bacteria retention	yes
Pallet	20 Boxes a 24 pieces
Manufactured for	Aqua Avanti Inline
Main location	Kitchen, Camper, Caravan
Min. operating power	approx. 1 bar - ideal 3,5 bar
Restrictions for use	Use only cold water - Not behind unpressurized boilers!

FP-7 INLINE

Art.No.	90000569
Shortcode	FP-7
Weight	680 g
Height	32 cm
Diameter	10 cm
Flow rate	pressure depend up to 4l/min
Performance	5.000 l
Box 24 pieces	60 x 40 x 35 cm
Weight 24 pieces	approx 20 kg
EAN Number	4250188804808
Changing interval	6 Months up to 5.000 l
Manufactured in	Germany
Virus reduction	yes
Bacteria and virus retention	yes
Filter inlet	Alstrom Disruptor®
Filter method	Static attraction
Pallet	20 boxes a 24 pieces
Manufactured for	Aqua Avanti Inline
Main location	Kitchen, Camper, Caravan
Min. working pressure	approx. 1 bar - ideal 3,5 bar
Restrictions for use	Use only cold water - Not behind unpressurized boilers!

FP-7 INLINE

As a supplement to our successful AA inline filter system, the FP-7 was developed. This additional stage filters viruses out of the drinking water and works with the patented Filter material Disruptor® from Ahlstrom. It is recommended to use the FP-7 after the pre-filtering and after the activated carbon block so that it can be used as long as possible. A solo use, or only with a pre-filter stage before it is also possible, but reduces the usage time and filter performance.

By cleverly wrapping the filter material and the resulting large surface, a Water flow of approx. 4 liters / min. and a usage time of up to 5,000 liters can be achieved.



INLINE CARTRIDGES

EM IFP PREMIUM 5 INLINE



EM IFP PREMIUM 5 - INLINE

The Premium EM Premium 5 Inline filter cartridge is combining water filtering and enlivenment in one cartridge. A "special clay" is used for the manufacture of the EM-ceramics, which contains the organic material of plants, which are millions of years old and are food for the EM™ Effective Microorganisms during the several month long fermentation process. Among other things EM ceramics reduces the surface tension of the water, and decreases the size of the cluster structures. In this way the natural condition of the water will be restored. The EM ceramics is "baked" into the filter cartridge during production. In this way there is a very large contact surface with the water. Together with the tried and tested filter ability, of CARBONIT® NFP Premium filter technology provides the ideal water filtration.

Water flow per minute approx. 4 l/min

Art.No.	88802286
Shortcode	FP-2
Weight	780 g
Height	32 cm
Diameter	10 cm
Flow rate	depending on pressure up to 4 l/min
Filter fineness	0,45 micron
Performance	approx. 5.000l
Box 24 pieces.	60 x 40 x 35 cm
Weight 24 pieces	ca. 20 kg
EAN Number	4250188802286
Changing interval	6 months up to 5.000 l
Manufactured in	Germany
Pollutant reduction	yes
Bacteria retention	yes
Pallet	20 Boxes a 24 pieces
Manufactured for	Aqua Avanti Inline
Main location	Kitchen, Camper, Caravan
Min. operating power	approx. 1 bar - ideal 3,5 bar
Restrictions for use	Use only cold water - Not behind unpressurized boilers!

SC-99 INLINE

Art.No.	88802217
Shortcode	FP-3
Weight	585 g
Hight	320 cm
Diameterr	10 cm
Flow rate	pressure depend up to 10l/min
Filter fineness	1 micron
Performance	10.000 l
Box 24 pieces	60 x 40 x 35 cm
Weight 24 pieces	approx 16,5 kg
EAN Number	4250188802217
Changing interval	6 Months up to 10.000 l
Manufactured in	Germany
Pollutant reduction	Sediment
Bacteria retention	yes
Pallet	20 boxes a 24 pieces
Manufactured for	Aqua Avanti Inline
Main location	Kitchen, Camper, Caravan
Min. working pressure	approx. 1 bar - ideal 3,5 bar
Restrictions for use	Use only cold water - Not behind unpressurized boilers!

SC99-INLINE

Pre-filter cartridge for AA Inline system. Reduction of the bacteria growth potential even in the pre-filter. SCI-99 is a special textile pre-filter, eg to remove strong particle-laden or polluted (turbidity) input water. It is made with an anti-bacterial protection. Due to the special winding, the protection is distributed over a very large area. Upon contact of bacteria with the protective surface the majority of bacteria cannot reproduce.

Water having a high content of sediments affect the optical in beverages and at worst can have a damaging effect on your system components.



INLINE CARTRIDGES

EM CALCI



Inline mineralisation cartridge with original Okinava calcium. EM Calci Inline is an optional mineralisation step which gives the filtered water a small amount of minerals. The installation should be in the AA Inline System before the prefilter. It can also be used on RO Systems (AA Calci Inline Main stage) either between the tank and the tap or directly after the reverse osmosis membrane. As the water flows very slowly over the coral calcium directly after the reverse osmosis membrane, this installation produces a greater level of mineralisation than installing the device between the tank and the tap.

EM CALCI

Art.No.	88802163
Shortcode	FP-4
Weight	ca. 1kg
Height	32 cm
Diameter	10 cm
Flow rate	Pressure depend approx. 4 l/h
Performance	5.000 l
Box 24 pieces	60 x 40 x 35 cm
Weight 24 pieces	ca. 25 kg
EAN Number	4250188802163
Changing interval	approx. one year
Manufactured in	Germany
Pallet	20 boxes a 24 pieces
Manufactured for	Aqua Avanti Inline
Main location	Kitchen, Camper, Caravan
Min. working pressure	approx. 1 bar - ideal 3,5 bar
Restrictions for use	Use only cold water - Not behind unpressurized boilers!

EK7 INLINE

Art.No.	88807984
Shortcode	FP-5
Weight	ca. 600 g
Height	32 cm
Diameter	10 cm
Flow rate	Pressure depend approx. 2 l/min
Performance	depending on the degree of hardness
Box 24 pieces	60 x 40 x 35 cm
Weight 24 pieces	ca. 15 kg
EAN Number	4250188807984
Changing interval	No later than 6 Moths
Manufactured in	Germany
Pallet	20 Boxes a 24 pieces
Manufactured for	Aqua Avanti Inline
Main location	Kitchen, Camper, Caravan
Min. working pressure	approx. 1 bar - ideal 3,5 bar
Restrictions of use	Use only cold water - Not behind unpressurized boilers!

EK-7

The EK-7 inline anti lime scale cartridge is used as additional stage before the prefilter or main filter stage. The ion exchange resin inside the cartridge is reducing the lime scale when the water flows over. The EK-7 is improving the taste of hot and cold drinks which will be prepared with the over flown water (specially coffee and tea) and is protecting your coffee machine, kettle etc. for too much lime scale. The water flow should not be higher than 2 l/min. in order to have an appreciable effect of lime scale reduction. As lower the water flow so higher the lime scale reduction.



HOME AND WELL WATER FILTER CARTRIDGES

In this category you will find suitable filter cartridges for our home and well water filtration system in 10" and 20" sizes.

Suitable for Aqua Fidelo

All filter cartridges can be used for the Aqua Fidelo and offer reliable filtration depending on the respective focus areas.

Safety and replacement information

The filter cartridges have to be replaced regularly. Precise information about the replacement intervals can be found in the relevant item table. However, an earlier replacement may be necessary if the water flow is noticeably reduced. This is generally an indication of the increased occurrence of fine particles in the unfiltered water.

Only use cold water, protect from frost

Standard filter cartridges for Aqua Fidelo

The following filter cartridges are included in the standard equipment for the Aqua Fidelo, in the case of a necessary filter cartridge replacement, these can be reordered from us or replaced with another filter cartridge from the same filter category:

- Pentek DGD
- Pentek carbon filter
- Pentek iron filter cartridge

HOME AND WELL WATER
FILTER CARTRIDGES



Model	Filter fineness	max. flowrate at 4 bar	Features
BB EM	1 µm		EM carbon filter
Pentek DGD Sedimentfilter	outside 25 µm, inside 1 µm	DGD 10: 40 l/min DGD 20: 60 l/min	2 stages sediment filter, thereby increasing the service life
Pentek Carbonfilter CBC	0,5 µm	CBC 10: 20 l/min CBC 20: 30 l/min	Extremely small filter fineness for large amounts of water
Pentek Carbonfilter EP	5 µm	EP-10: 40 l/min EP-20: 50 l/min	Ideal Carbonfilter. We recommend sediment pre-filter
Pentek EisenFilterpatrone	-	RFFE-10: 14-20 l/min RFFE-20: 14-25 l/min	Effective iron is dissolved or reduced from the water

BB 10 EM - BB 20 EM

World innovation 2020

Exclusive to Prime Inventions

Now you can also use the proven combination of Carbonit activated carbon block and EM for the entire house water filtration. The two 10 „and 20“ EM activated carbon filters from Carbonit® are ideally suited for our AquaFidelo house water filter housings, exclusively for Prime Inventions manufactured. Of course, the two filter cartridges also fit into the housings of many other manufacturers. A high fineness of 1 my could be achieved and only a slight reduction in the water flow, which is very important for filters for the whole house.

The BB EM cartridges combine pollutant filtering of undesirable substances in the water such as B. rust particles or organic particles, removal of odor pollution such as chlorine and medication residues in the water and the excellent EM ceramic properties in one cartridge.

For more information on EM filter cartridges, see page 68.



BB 10 EM - BB 20 EM

	BB 10 EM	BB 20 EM
Art.No.	88804877	88804860
Shortcode	BBEM10	BBEM20
Dimensions	25,4 cm,	50,8 cm
Diameter	B 14 cm	B 14 cm
max flowrate	24 l/min	48 l/min
Filter material	EM-ceramics and carbon	
Customs number	84219900	
EAN number	4250188804877	4250188804860

Filter fineness	1 my
Change interval	6 months
Made in	Germany
Retention	u. a. hormone-like substances, Pesticides, heavy metals and Drug residues
Made for	Aqua Fidelo Filter 10“ + 20“
Min. pressure	approx. 1 bar, ideal 3-4 bar
Usage restrictions	Use only with cold water Protect from frost

HOUSE + WELLWATER

PENTEK DGD 2 STAGES SEDIMENT FILTER

The DGD Series' advanced design combines selective final filtration with appropriate pre-filtration to achieve up to three times the dirt-holding capacity of similar size sediment cartridges and even greater capacity than standard spun or stringwound cartridges. This performance enhancement is achieved by combining two separate gradient layers in one filter. The



larger diameter of the pre-filter reduces the particle load to the post filter, allowing it to operate at higher velocities. The effective filter depth is increased to a full 233% of standard spun-polypropylene or string-wound filters. This increased depth provides for very high particulate reduction efficiencies and added loading capacity.

PENTEK DGD

Art.No.	DGD-10" = 88810232 DGD-20" = 88810233
Shortcode	DGD 10 DGD 20
Filter fineness	outside 25 µm, inside 1 µm
max. flowrate at 4 bar	DGD 10 = 10" 40 l/min DGD 20 = 20" 60 l/min
Temperature	Only cold water up to 30°C, protect for frost
Dimensions	H 10" 25,4 cm W 12 cm H 20" 50,8 cm W 12 cm
Filter material	blown polyester, food safe, NSF® certified-from PENTEK/PENTAIR™ USA
Packaging unit	8/6
Weight 24 pieces	10" = 431 g
EAN Number	DGD-10" = 4250188802606 DGD-20" = 4250188802866
Min. working pressure	1 bar - ideal 3,5 bar

PENTEK CARBON

Art.No.	CBC-10" = 88831059 CBC-20" = 88831058
Shortcode	CBC-10 CBC-20
Filter fineness	0,5 µm = 0,0005 mm
max. flow rate 4 bar	CBC 10 = 20 l/min CBC 20 = 30 l/min
Temperature	Only cold water up to 30°C, protect for frost
Dimensions	H 10" (10 Zoll), 25,4 cm, W 14 cm H 20" (20 Zoll), 50,8 cm, W 14 cm
Filter material	blown polyester, food safe, NSF® certified-from PENTEK/PENTAIR™ USA
Packaging unit	8/4
Weight	CBC-10" = 1,5 kg CBC-20" = 3,2 kg
EAN Number	CBC-10" = 4250188803368 CBC-20" = 4250188803375
Min. working pressure	1 bar - ideal 3,5 bar

PENTEK CARBON CARTRIDGE

Fine filtration for well water

CBC Series cartridges are highly effective at reducing unwanted tastes and odors, including chlorine taste & odor and other contaminants.

CBC Series cartridges are an ideal choice for a wide range residential, food service, commercial and industrial applications. They also make excellent polishing filters or pre-filters in applications requiring fine filtration and high capacity.



HOUSE + WELLWATER

PENTEK CARBON-BRIQUETTE CARTRIDGES



EP Series carbon briquette cartridges are manufactured using a patented process that yields a cartridge with a nominal 5-micron filtration rating, high dirt-holding capacity. A high porosity design helps prevent the cartridge from plugging before its adsorption capacity is exhausted, maximizing the utilization of the carbon while maintaining low pressure drop.

PENTEK CARBON EP

Art.Nr.	EP 10 = 88831055 EP 20 = 88831053
Shortcode	EP-10 EP-20
Filter fineness	5µm = 0,005 mm
max. flow rate at 4 bar	EP 10 = 40 l/min EP 20 = 50 l/min
Temperature	Only cold water up to 30°C, protect for frost
Dimensions	H 10" (10 Zoll), 25,4 cm, W 14 cm H 20" (20 Zoll), 50,8 cm, W 14 cm
Box	EP 10 = 26 x 12 x 12,5 cm EP 20 = 52 x 12 x 12 cm
Weight	EP 10 = 1,2 kg EP 20 = 2,8 kg
EAN Number	EP 10 = 4250188803344 EP 20 = 4250188803351
Mon. operating power	ca. 1 bar
only with cold water - protect from frost	

PENTEK IRON REDUCTION

Art.No.	RFFE10 = 88831099 RFFE20 = 88831052
Shortcode	RFFE10 RFFE20
Iron-reduction	max. 3 mg/l
Max. value of to be filtered water	pH > 6,8 - Mangan max. 0,1 mg/l
Silikate	max. 100 mg/l
max. flowrate at 4 bar	RFFE 10" = 14-20 l/min RFFE 20" = 14-25 l/min
Dimensions	RFFE 10" 25,5 x 11,5 cm RFFE 20" 51,0 x 11,5 cm
Temperature	Working temperature 1-40°C- protect from frost
Box	RFFE20 52,5 x 12,5 x 12 cm
Box PU 8/4	54,5 x 26,5 x 26,5 cm
EAN Number	RFFE 10" = 4250188802040 RFFE 20" = 4250188802293
Min. working pressure	approx. 1 bar - ideal 3-4 bar
only with cold water - protect from frost	

PENTEK IRON REDUCTION

The RFFE20-BB filter cartridge is designed to provide an easy and effective method of reducing iron from water, which greatly improves the taste. This cartridge helps to eliminate the orange and brown stains often found in sinks, toilets, tubs and other plumbing fixtures. It also reduces the possibility of damage to pipes and water heaters and reduces up to 3 ppm dissolved iron. It adds no harmful chemicals to the water, making it completely safe for drinking water applications.



PENTEK™ RFFE 10"

1 mg/l: ca. 150.000 l

2 mg/l: ca. 75.000 l

3 mg/l: ca. 50.000 l

PENTEK™ RFFE 20"

1 mg/l: ca. 300.000 l

2 mg/l: ca. 150.000 l

3 mg/l: ca. 100.000 l

BIG GREEN CARTRIDGES



Limescale protection cartridges

Only compatible with BigGreen Limescale Protection Device

- Big Green protects your entire piping system, your appliances and equipment from aggressive lime deposits, which leads to unnecessary defects and corrosion.
- Reliable reduction of limescale deposits in the entire piping system - Reduction of chlorine and poisonous chemicals
- Less time and expenditure for repairs, maintenance and cleaning
- Considerable savings on washing and cleaning agents
- Reduced energy costs due to improved efficiency
- Improved equipment performance - no waste of space
- No use of salt, chemicals or electricity
- Big Green works with all raw materials: iron, copper, steel, plastic, PVC, PEX.
- Suitable for pipe diameters from 1/2" to 1"
- Core components manufactured in Canada
- Tested by independent institutes with references

Three-stage treatments

- 1. High sediment capacity**
(Dirt-holding capacity up to 1 kg), 20 micron pre-filter
- 2. Chlorine reduction, reduction of toxic chemicals,**
improvement in smell and taste
- 3. Patented BigGreen (TAC),**
prevention of deposits with high flow rates

KI BIG GREEN CARTRIDGES

	both cartridges	only carbon filter
Art.No.	90000481	90000480
Shortcode	KI-BG-TAC	KI-BGC
Empty weight	2,9 kg	2,3 kg
Height	ca 35 cm	ca. 33,4 cm
Diameter	15 cm	7 cm
Box	approx. 36 x 16 cm	
Customs number	84219900	
EAN Number	4250188803634	4250188803641

pH	6,5 bis 8,5
Hardness	1300 ppm CaCO ₃
Chlorine	<3 ppm
Ferrum	<0,3 mg / l
Manganese	<0,05 mg / l
Copper	<1,3 mg / l
Sedimentfiltration	20 microns with a dirt holding capacity of up to 1 kg
Chlorine reduction **	189.000 Liter at 11,34 lpm
Prevention of deposits ***	3 years or 1.890.000 l

** According to the specification of the manufacturer of the carbon block

*** Depending on the local water chemistry

HOUSE + WELLWATER



carbonit® QUADRO 60 / 120
FILTER MADE IN GERMANY

Monoblock WFP for Quadro

CARBONIT Monoblock® - made baked block filter in the sintering process, patented internationally recognized numerous awards and scientific. (Not to be confused with loose beds of coal pellets or extruded blocks). LGA-tested safety in accordance with German food law. (Also complies with DVGW worksheet W 270). Only original replacement cartridges provide a function CARBONIT® warranty and the peace of mind, use and quality controlled products.

Parameter	Reduction	Certified
Lead ¹ Copper ¹	>90% >90 %	TÜV Umwelt TÜV Umwelt
Bacteria ² , yeasts Microorganisms, fungi	>99%	GFT/ Uni Bielefeld
Chlorine ² , Chloroform ² Lindan ² DDT ² , Atrazin	>99%	tti Magdeburg GmbH/ FH Magdeburg
medication residues, ² polar pesticide. ²	>99%	TU Berlin

Pollutant and bacteria retention

This block filter combines the familiar forces of sintered activated carbon adsorption with mechanical filtration. The Select cartridge is factory installed in Quadro filter systems. Good protection against particulates, chlorine taste and organic compounds.

Only for use in QUADRO devices. For technical reasons, the usage of the cartridge is only allowed for cold water up to max. 28 degrees Celsius permitted, please protect from frost. Recommended filter change every 6 months.

¹ test with exposure over a useful life of 6 months
² test with load over filter capacity of 10,000 liters

	Premium	Protect	Select	Spezial
Art.No.	210WFP020(L)	210WFP120(L)	210WFP220(L)	210WFP400(L)
Shortcoder	WFP Premium (L)	WFP Protect (L)	WFP Select (L)	WFP Spezial (L)
Weight	638 g / 1276 g			
Height	25,3 cm / 45,9 cm			
Diameter	8,4 cm			
Flow rate	3,5 (7) l/min	12 (24) l/min	24 (48) l/min	40 (80) l/min
Filter fineness	0,45 µm	5 µm	10 µm	20 µm
Box	24 (8) pieces			
Box PU 24 pieces.	60 x 40 x 30 cm			
Weight PU 24 pieces	16 (11,5) kg			
EAN Number	4024875143439 (4024875143446)	4250188804464 (4250188804457)	4024875900223 (4024875900230)	4024875143804 (4024875143811)

(Values in brackets apply for long version)

The filter cartridge should be replaced after 6 months of use (based on DIN1988 - EN1717 (or 806). Within this time, up to 60,000 liters water (WFP Spezial L) can be filtered:

WFP Premium	12.500 l
WFP Premium L	25.000 l
WFP Protect	22.500 l
WFP Protect L	45.000 l
WFP Select	26.000 l
WFP Select L	52.000 l
WFP Spezial	30.000 l
WFP Spezial L	60.000 l

MEMBRANE FILTER



MF-2000 MEMBRANE FILTER

Containment of Viruses and Bacteria

The MF-2000 membrane filter is used as the sole filter or to expand an existing filter system for the containment of viruses and bacteria. Even if the filter stages used of the standard filter system are already bacteria-proof, you expand this with the MF-2000 for additional containment of viruses in water. When using filter systems that do not allow any bacterial containment by themselves, the MF-2000 is the ideal supplement. Through the practical 1/2" connection, the MF-2000 can also be used as a shower filter to protect against bacteria.

Attention:

since a lot of water is used while showering, the capacity of the MF-2000 is used up after approx. 30 showers. The MF-2000 is also ideal when travelling, to protect yourself from unpleasant surprises in the shower.

Optional

Hose plug connection on 3/8" GNP threads for connection of reinforced hoses

Note

If activated carbon filters are used before the MF-2000, these should be rinsed free without the MF-2000 - as indicated by the respective manufacturer. CARBONIT® activated carbon filters should be activated, e.g. for the first use, with running water for approx. 5 minutes. In the process, some activated carbon is flushed out that is not harmful to health. If the activated carbon gets stuck in the MF-2000, however, the usage time is then limited.



MF-2000

Art.Nr.	88802507
Shortcode	MF-2000
Weight	approx. 86 g without Adapter
Diameter	4 cm
Length with adapter	19,8 cm
Filter fineness	0,02 micron
Material	Polypropylen
Connection thread	1/2" IG input 1/2" AG output
Flow rate	ca. 4 l/m
Performance	ca. 3.000 Liter

Packaging unit	1 piece
customs number	84219900
EAN Number	4250188802507
Scope of delivery	Filter, wall mount, adapter
Main location	Kitchen, shower
Min. operating pressure	approx. 1 bar -ideal 3,5 bar
Restictions of use	Use only cold water Not behind unpressurized boilers!



LINEGUARD

Effective and reliable point-of-entry filtration

The LineGuard compact water systems produce safe, purified water in applications where high flow rates, long service life, low maintenance and compact design are decisive. The core of every LineGuard system is formed by the reliable and state-of-the-art Norit X-Flow ultrafiltration membrane modules, which are successfully employed in the world's most advanced water purification plants. The systems work on waterline pressure and have a built-in controller for automatic backwash and forward flush cleaning cycles. The LineGuard UF-100 has two ultrafiltration (UF) modules, with billions of microscopic pores small enough to retain all microorganism, sediment and turbidity, but large enough to allow vital minerals through. LineGuard modules are tested on microorganism retention by independent testing laboratories and can meet every relevant standard in the water industry. Lineguard products and components are subjected to strict quality control procedures. Each product is individually checked for its effectiveness.

The LineGuard UF-100 has a capacity of 3.6 m³/hour. The capacity can be increased by fitting two or more systems in parallel. The LineGuard can be deployed as a compact water treatment system or as a gatekeeper Legionella prevention system. Applications include:

- Whole house water treatment to improve tap water quality for drinking and food preparation
- Well water treatment in remote areas
- Healthcare centers where people are at particularly high risk of infection by waterborne pathogens
- Hotels and restaurants to guarantee safe and first-class water for drinking and food preparation
- Legionella prevention for shower rooms in public buildings

LINEGUARD

Art.No.	88800558
Shortcode	LG-1
Weight	40kg
Dimensions	115 x 31,6 x 20,9 cm
Flowrate	60 liters / min at 2 bar, sufficient for connecting 4 water taps
Total capacity	> 5.000 m ³
Cleaning cycles	Backwash and forwardwash
Membrane area	4,5 m ²
Biological retention	Viruses >99,99 % (log 4) Bacteria >99,99999 % (log 7)
Material safety	Extraction tests according to NSF / KTW

Connections	Inlet water: 22 mm, 3/4 in Permeate: 22mm, 3/4 in Drain connection: 22 mm, 3/4 in
Ambient temperature	min. +1°C, max. +50 °C
Inlet water	min. +1°C, max. +40 °C
Max. Inlet pressure	4 bar
Packaging unit	1 piece
Customs number	84219900
EAN Number	4250188800558
Replacement membrane	
Art.No.	90000448
EAN Number	4250188804754
Usage restrictions!	Use only with cold water

EXHIBITIONS

Prime Inventions
at trade fairs worldwide.
Here are some examples:



Malaysia - Kuala Lumpur



Singapore



Biofach Baltimore - USA



Water EX - Peking



European Gateway Tokio - Japan

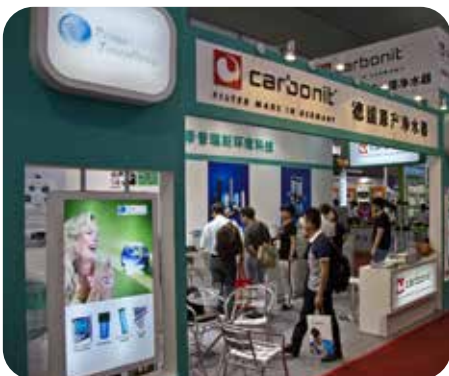

Aquatec Shanghai - China

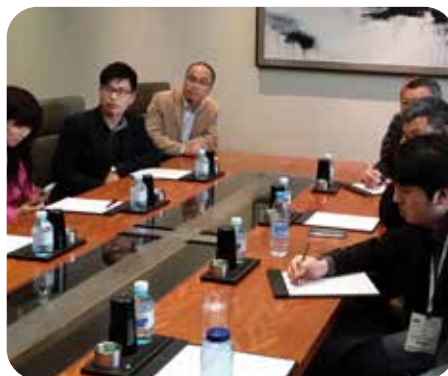

Workshop - China

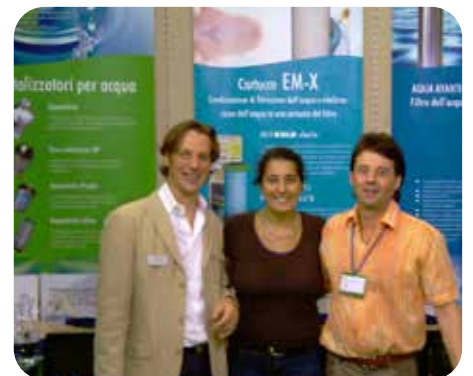

Sana Bologna - Italy



Vivanness/Biofach - Germany



Biocultura Madrid - Spain



Biofach India - India



Prime Inventions GmbH

Gerkens Hof 11
33758 Schloss Holte-Stukenbrock
Germany

Tel.: +49 (0) 5207 - 510 96 - 0
Fax: +49 (0) 5207 - 510 96 - 99

E-Mail: info@prime-inventions.de
Internet: www.prim-inventions.de

Your distributor: